



Eurocell Building Plastics Specification Guide

Roofline
Composite doors
Conservatory roofs
Finishing trims
...and more!



All together better



Introducing roomline

Discover the future of skirting boards and architraves



Simply better - No preparation, no painting, no problem

At last, a high-quality, no-maintenance, easy-fit alternative to timber skirting boards and architraves from Eurocell.

Say goodbye to sanding, painting and lifetime maintenance – and cut installation times by up to 50%.

- No sanding, no painting, no treatment – ever
- Glue-on fitting with standard adhesives
- No maintenance – just wipe clean
- Durable, scratch resistant finish
- Integral low-voltage cable tidy solution

Call Eurocell today to request your FREE roomline DVD:

0800 988 3044

Alternatively, visit our website: eurocellroomline.co.uk



All together better

Contents



All together better



Introducing Eurocell	4	Roomline skirting boards and architraves	36
Our product range	6	Composite doors	42
Roofline	8	Conservatories	48
Fascia board	10	Silicone sealants	52
Capping board	14	Technical information	54
Soffit board	18	Accreditations	55
Cladding	20	What our customers say	56
Roof ventilation and eaves protection	24	Full product range - at a glance	58
Rainwater systems	26	Complete range colour guide	61
Dry verge	30	Branches nationwide	66
Finishing trims and fixings	32		
Roofline finishing trims	33		
Window finishing trims - internal use	34		
Window cills and accessories - external use	35		

Discover Eurocell

The UK's leading PVC-U specialists



Eurocell plc manufactures and distributes the widest product range of any PVC-U systems supplier in the UK. We produce a comprehensive choice of window, door, conservatory and roofline products in our 25,000m² state-of-the-art facilities, as well as a full range of essential ancillaries.

Guaranteed colour match

Because we manufacture our own products, we can guarantee an exact colour match across our full range of systems for the entire building envelope. That means you can specify Eurocell windows, doors, roofline and conservatory roofs, with the assurance of precise colour co-ordination across the entire property.

Quality controlled manufacturing

Quality is carefully controlled and monitored throughout the manufacturing

process for all Eurocell products. We have our own toolmaking and laminating facilities, and all products are manufactured using raw materials from our own PVC-U compound mixing plant, giving us full control over product quality and consistency, right from the start.

Sustainable champions

We re-use almost 100% of our waste product in the manufacturing process, which amounts to almost 3,000 tonnes per year. That means virtually zero production waste goes into landfill. We also operate a technically advanced post-consumer PVC-U recycling plant in the UK, enabling us to recycle old window frames that would otherwise go to landfill. Our commitment to sustainability is demonstrated by our ISO14001 environmental management systems accreditation and our extensive use of recycled waste materials in our products.

Just-in-time deliveries – nationwide

To ensure you receive the products you need, just when you need them, we offer a comprehensive delivery service, nationwide. Our role as both manufacturer and distributor means we can supply quality-assured products directly to building projects anywhere in the UK, providing a fast and efficient service for national agreements and project material call-offs.

We even offer free delivery of many products within 24 hours from our nationwide network of more than 125+ Eurocell branches.

Eurocell Building Plastics is a trading company of Eurocell plc specialising in roofline, conservatory roof, window trim and door products, as well as all the fixings, sealants and tools required



for every building plastics job. Our branches are unique in the market because most of the products we stock are manufactured by us. This gives us complete control over the supply chain, resulting in quicker turnaround of orders, greater delivery reliability and consistently high-quality products.

Free next-day delivery

You can order any of our products from your local branch for free next-day delivery to any site in the UK using our own delivery fleet*. Or you can collect from any of our 125+ branches across the UK.

Unrivalled service support

When you choose Eurocell products you'll also enjoy unrivalled support from our teams of experienced PVC-U specialists. Our technical team is on hand to help you with specification and regulatory

advice, our in-house marketing support team can help you to promote our products to your customers, while our commercial business development team will help you to maximise your sales.

* Orders over £100 excluding VAT. Delivery to mainland UK only, excluding weekends and Bank Holidays



Manufacturer of the year



Our role as both manufacturer and distributor means we can supply quality assured products directly to building projects anywhere in the country

Our product range



Eurocell Building Plastics offers a comprehensive range of PVC-U roofline, door, conservatory roof and associated components. Our branches stock more than 4,000 products, providing a complete one-stop-shop for all your building plastics requirements

Quality and value

Our product range has been carefully compiled to ensure that we offer a high-quality solution for every area of building plastics construction. All products are designed to deliver optimum performance as well as maximum value for money. We are able to control our prices because many of the products stocked in our branches are also manufactured by us.

Product range you can rely on

You can be sure that you'll find the same range and standard of products whenever you call in to any of our branches. That's because, unlike other stockists, we'll never be changing our profiles supplier. It means you'll find fully compatible products no matter which branch you visit – anywhere in the UK.



Our nationwide network of 125+ branches means we can provide free delivery within 24 hours of order



Roofline





High-performance products

Fascias, soffits and associated roofline accessories are essential components for any property. Exposed to the elements and playing a crucial role in protecting the roof space and rafters, these vital products need to be hard-wearing, weather-resistant, long-lasting and – due to their difficult-to-access location – low maintenance. PVC-U products from Eurocell meet and exceed all of these requirements.

Complete roofline systems

Eurocell offers everything you need for a complete, high-performance roofline system, manufactured to the highest quality standards. From fascias, soffits and guttering to dry verge, over-fascia ventilation and all the trims and accessories to complete the job – everything is available from your nearest Eurocell branch.

Up to 20-year guarantees

As well as an exact colour match across our full range of products, we also offer guarantees of up to 20 years against discolouration, warping and cracking on our roofline product range.



Eurocell Building Plastics Ltd, in conjunction with its raw material suppliers, guarantees for a period of 20 years* all its white PVC-U roofline products against discolouration, warping and cracking



Eurocell Building Plastics Ltd, in conjunction with its raw material suppliers, guarantees for a period of 10 years* all its laminated boards against discolouration, warping and cracking

Euroboard 18mm fascia board



Fascia board is a direct fix product designed for ease of fitting, with low maintenance results. Ideal for both new homes or replacement projects

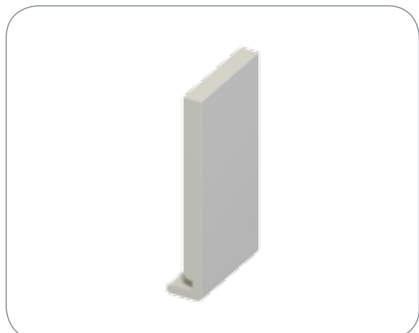

Euroboard 18mm standard

As the flagship Eurocell fascia board, Euroboard is the perfect direct replacement board to make an attractive improvement to any home

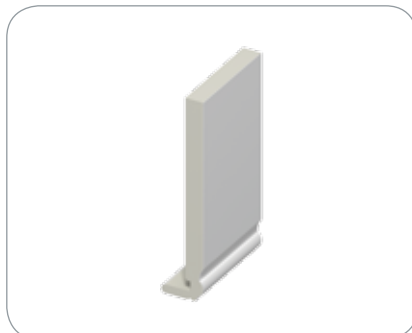

Euroboard 18mm ogee

Replacement ogee fascia system, a more decorative alternative to standard fascia board, ideal for new build and refurbishment projects

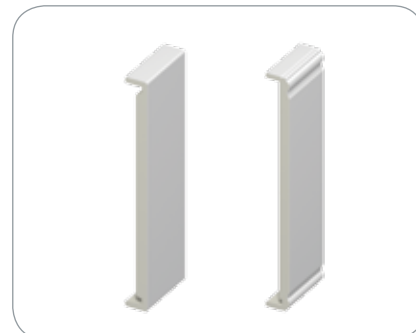

Double Euroboard standard and ogee

Double Euroboard fascia board is for use on box ends

Accreditations



The Eurocell roofline system Assessment report number 01/3783

Colour options

Standard colour options and finishes:

Our range of Euroboard will enhance any home and is available in colours and styles to suit all tastes. Boards are easy to fit and are fully compatible with our soffit systems for an exact colour match. Colours precisely match our window and door profile systems too!



Note: Not all fascia boards are available in the full range of colours above. For a comprehensive colour availability checklist for each product, see page 61.

Ogee-style Euroboard is available in White only



Euroboard plain fascia in White

As the flagship Eurocell fascia board, Euroboard is the perfect product for new homes or for replacing old fascias. Available in standard profile or a distinctive sculpted ogee style, Euroboard is easy to fit and makes a smart improvement to any home.

At 18mm thick, the boards are sturdy enough to be attached directly to rafters, helping to reduce the cost of fascia replacement. This robust fascia system is designed for long life and low-maintenance, with no painting required.

Euroboard fascias are designed to complement our soffit board range, but are also compatible with all other types of soffit – giving you a choice of styles for your roofline.

Fixing instructions



18mm foam fascia detail

- 1**
Designed for a direct fix, and eliminating the need for a timber substrate, these 18mm thick fascia boards can be secured direct to the rafters at a maximum of 600mm centres using 2 x 65mm A4 stainless steel fixing nails per rafter
- 2**
Care should be taken to ensure that the rafters are level
- 3**
Where any White corner trims, joint trims or angle trims are required, the boards should be cut back 5mm per edge to allow for expansion. If laminated boards are used, the dimension increases to 8mm per edge, and all trims should be secured by gluing one side and leaving the other free for any expansion or contraction
- 4**
The guttering should be secured to every third rafter, although these boards are thick enough to hold extra fixings securely at other points

Please note:

Foiled and laminated boards should be fitted in lengths of **2.5m maximum**, to accommodate the expansion requirements, especially on south facing elevations



9mm foam soffit detail

- 1**
Ensure that prior to fixing soffits, the preservative treatment to the structural timber has dried out
- 2**
All utility boards 100mm-605mm in width should be fixed at a maximum of 600mm centres
- 3**
If ventilation is required, the Eurosoffit board available in 150mm-605mm widths gives the 10mm air gap required for roofs with a pitch in excess of 15°
- 4**
An alternative method of soffit ventilation sees the rigid soffit ventilator joining the Euroboard to the utility boards.
- 5**
If roofspace ventilation has been created by using the over fascia ventilation, the utility board is fitted on top of the ogee or Euroboard leg and secured to the soffit batten using 30mm A4 stainless steel fixing pins



9mm hollow soffit detail

- 1**
Available in 300mm and 100mm widths, these alternative soffit boards can be fitted at right angles or parallel to the full replacement boards giving an attractive tongue and groove effect
- 2**
If no ventilation is required, the hollow soffit can be used on top of the Euroboard leg and fitted to the soffit batten using 25mm cladding pins. If ventilation is required, these boards can also be pre-vented and fitted in the same way
- 3**
A soffit ventilator profile can be used to join the Euroboard fascia and hollow soffit board. If the hollow soffit board is running along its length, the first plank should have the location leg removed, allowing it to fit into the soffit ventilator

Please note:

Hollow soffits are not designed to be used as external cladding or a fascia system. Failure to comply will invalidate the guarantee

Diagrams

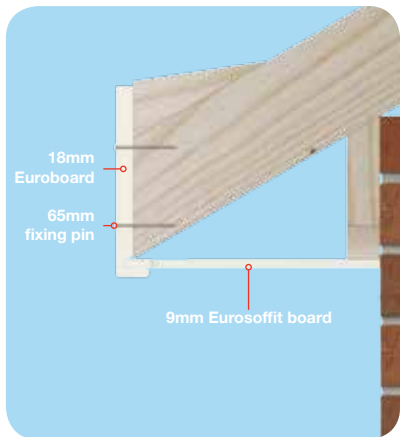

18mm Euroboard fixed directly to the rafter ends, incorporating the 9mm pre-vented Eurosoffit board supported by a timber noggin across the top course of brick work

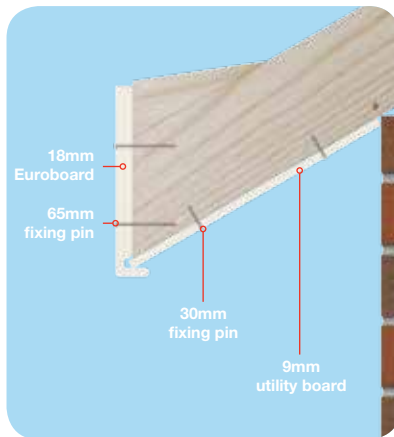

18mm Euroboard profile fixed directly to the rafter ends. Due to the unique design of the angle groove, sloping soffits up to a pitch of 45° can be accommodated using a 9mm utility board

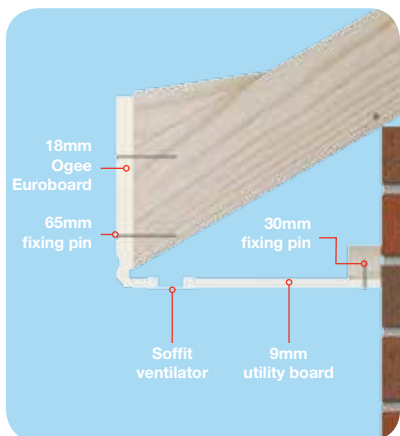

18mm Ogee Euroboard can be used in conjunction with the soffit ventilator and utility board to form the soffit

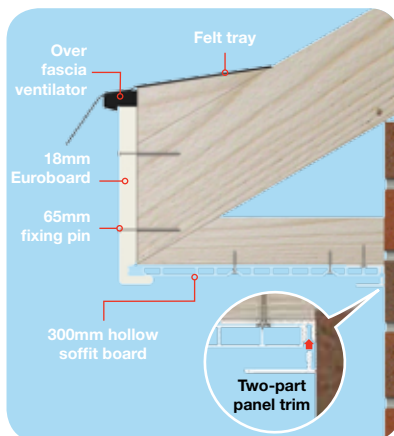

18mm Euroboard fixed directly with 25mm pins to the rafter ends incorporating the 300mm rigid hollow soffit board, secured with the two-part panel trim. Over fascia ventilator on the top of the Euroboard allows air into the roof space

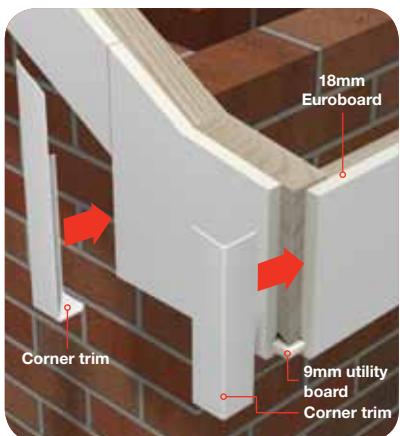

A gable box end finished with corner trims

Examples of use



18mm Euroboard and 9mm Eurosoffit board



18mm Ogee Euroboard and rigid soffit ventilator with 9mm utility board



18mm Ogee Euroboard and 300mm vented hollow soffit board



The Euroboard design helps to accommodate a sloping soffit

Capping board 9mm



Eurocell capping board is the PVC-U system of choice for fitting new fascias directly on top of existing timber

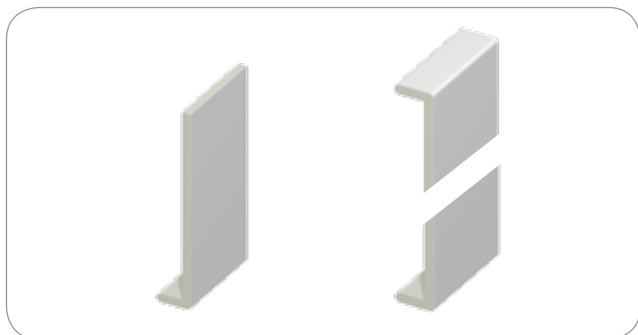

Capping board 9mm standard and double

Stylish and cost-effective PVC-U boards designed to be fitted over existing sound timber fascias or a timber backboard support

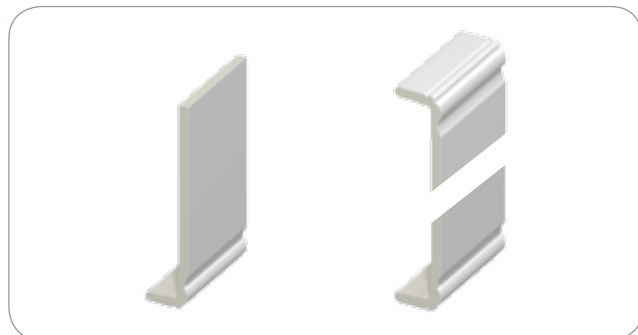

Ogee capping board 9mm standard and double

A more decorative alternative to our straight-edged capping board

Accreditations



The Eurocell roofline system Assessment report number 01/3783

Colour options

Standard colour options and finishes:

Our range of standard and double capping boards will enhance any home and are available in colours and styles to suit all tastes. The boards are easy to fit and are fully compatible with our soffit systems for an exact colour match. The colours precisely match our window and door profile systems too!



Note: Not all capping boards are available in the full range of colours above. For a comprehensive colour availability checklist for each product, see page 61.



Capping board forming a box end in White

Eurocell capping board is the PVC-U system of choice for fitting new fascias directly on top of existing timber. The 9mm thick plastic capping board is available in a choice of standard or sculpted ogee styles to suit any home. It's an attractive, easy to install solution for any replacement roofline project.

The board is designed for ease of fitting and low maintenance, with no painting required. It is simply attached to the existing timber fascia or, where the fascia has rotted, to a new timber backboard for a first-class, long-lasting installation.

Our capping board is compatible with a whole range of soffit styles, giving you even more choice in the appearance of your roofline.

Please note: Corner trims should be glued, not nailed

Fixing instructions



9mm foam fascia detail

- 1**

All existing fascia material should be removed, and structural timbers checked for any evidence of rotting (and replaced, where required, using treated timber). Likewise the roofing felt should be inspected for any sign of damage and replaced accordingly
- 2**

All standard and ogee capping boards 150mm - 300mm in depth should be fixed to a 6mm external quality plywood backboard, ensuring the profile follows a straight line between the rafter. Although not advised if secured to an existing timber fascia, all rotten wood must be removed and replaced with timber that has been treated with a wood preservative
- 3**

The capping boards should be secured to each rafter using 2 x 50mm stainless steel nails. These products are not load bearing, and all roof tiles must be supported by a tilting fillet, which deflects the bottom tile from the top of the fascia
- 4**

The fixing of finishing trims follows the same procedure as the thicker Euroboard fascias (see page 13),

9mm foam soffit detail

- 1**

Ensure that prior to fixing soffits, the preservative treatment to the structural timber has dried out
- 2**

All utility boards 100mm-605mm in width should be fixed at a maximum of 600mm centres
- 3**

If no ventilation is required, the utility board is fitted on top of the capping board leg and secured to the soffit batten using 30mm stainless steel fixing pins
- 4**

If soffit ventilation is required, the Eurosoffit board (available in 150mm-605mm widths) gives a 10mm or 25mm air gap required for roofs with a pitch in excess of 15°
- 5**

An alternative method of soffit ventilation sees the rigid soffit ventilator joining the capping board to the utility board

9mm hollow soffit detail

- 1**

Please follow the details shown on page 13, substituting the 18mm Euroboard full replacement system with the 9mm capping board replacement system

Please note:

Hollow soffits are **not designed** to be used as external cladding or a fascia system. Failure to comply will invalidate the guarantee.

Foiled and laminated boards should be fitted in lengths of **2.5m maximum**, to accommodate the expansion requirements, especially on south facing elevations.

Diagrams

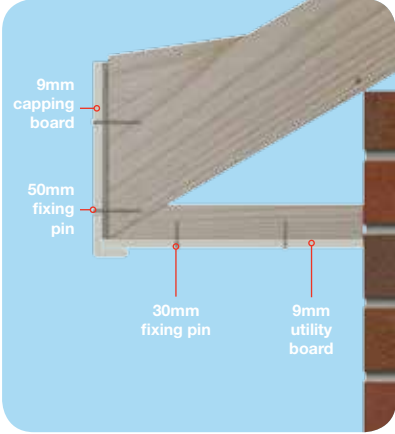

9mm capping board with new timber backboard and 9mm utility board

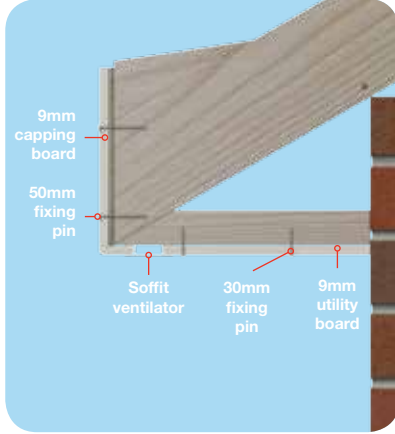

9mm capping board with new timber backboard featuring the 10mm airspace soffit ventilator with 9mm utility board

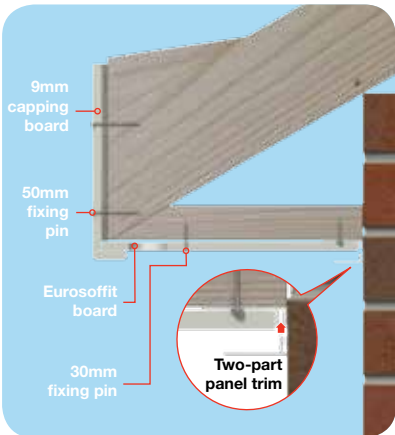

9mm capping board with new timber backboard featuring Eurosoffit board, finished with two-part panel trim

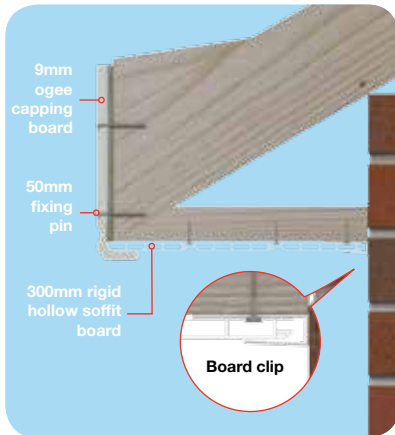

9mm ogee capping board with new timber backboard featuring the 300mm rigid hollow soffit running parallel to fascia, finished with a board clip

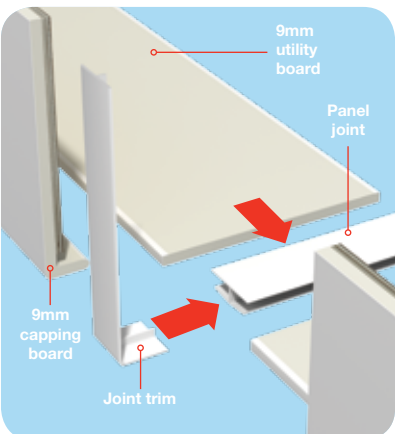

Panel joint and joint trim

Please note:
All fascias are shown affixed to a timber backboard, with timber fillets for additional support

Examples of use



9mm capping board with 9mm utility board, fitted to a new 6mm plywood substrate



9mm capping board and 300mm hollow soffit board



Joint detail



Gable end showing corner trims

Soffit board



Eurocell manufactures a complete range of soffit boards that perfectly complement our fascias. These high quality components give your roofline an attractive, clean-edged finish and require minimal maintenance

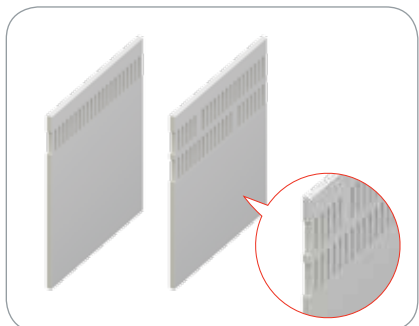

Eurosoffit board 10mm & 25mm airspace

With built-in ventilation slots (10mm or 25mm) to ensure the roof is well ventilated at all times, preventing damp and protecting rafters from rot

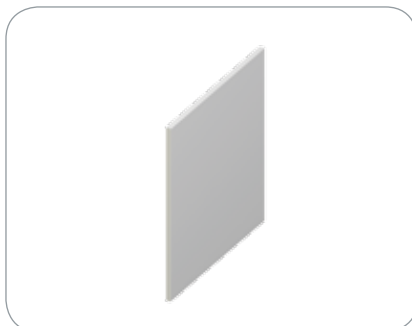

9mm utility board

Provides a simple, clean look. See page 24 for ventilation accessories to maintain airflow through the roof space

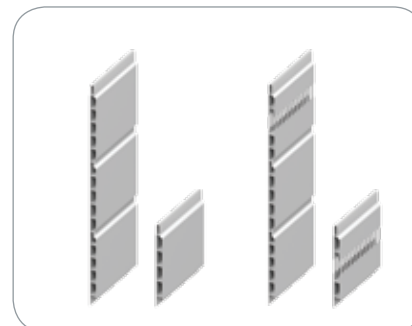

Hollow soffit board standard & vented

A lightweight, cost-effective soffit solution, which can also be fitted with our highly effective ventilators

Accreditations



The Eurocell roofline system Assessment report number 01/3783

Colour options

Standard colour options and finishes:

Our stylish soffits will enhance any home and are available in colours and styles to suit all tastes. Soffits are easy to fit and are fully compatible with our fascia systems for an exact colour match. The colours precisely match our window and door profile systems too!



Note: Not all soffit boards are available in the full range of colours above. For a comprehensive colour availability checklist for each product, see page 61.

Eurosoffit board (25mm airspace) is available in white finish only



Vented hollow soffit board in White



Utility board in White

Cladding



Eurocell PVC-U cladding provides an attractive, low maintenance, weather resistant solution for replacing rotten timber cladding, concealing problem areas of brickwork or adding an interesting new feature to a property

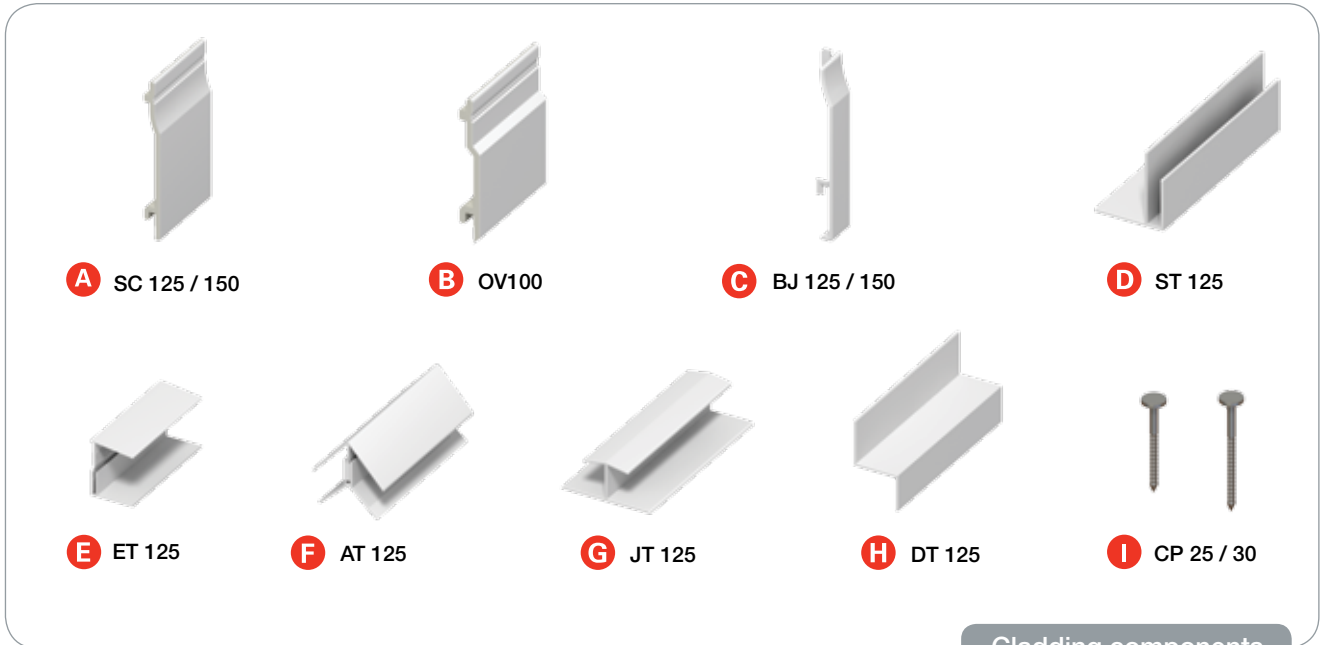

Cladding components

Accreditations



The Eurocell cladding system Assessment report number 01/3784

Colour options

Standard colour options and finishes:

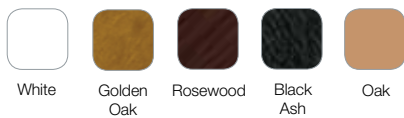

Note: Not all cladding is available in the full range of colours above. For a comprehensive colour availability checklist for each product, see page 61.

Cladding

Eurocell PVC-U cladding provides an attractive, low-maintenance, weather-resistant solution for replacing rotten timber cladding, concealing problem areas of brickwork or adding an interesting new feature to a property.

Available in shiplap or open-V styles, our cladding is designed for easy installation with a simple clip-together fitting system. Our range of colours and realistic woodgrain finishes means you can create a truly unique appearance, whether you want a rustic timber-effect or a crisp contemporary white finish.

The colours available are exactly matched with Eurocell windows, doors and roofline products for a consistent look across any home.

- A** 125mm and 150mm shiplap cladding **SC 125 / 150**
- B** 100mm open V cladding **OV100**
- C** Butt joint (available in 100mm, 125mm and 150mm) **BJ100 / BJ125 / BJ150**
- D** Starter trim **ST125**
- E** 2-part edge trim **ET125**
- F** 2-part angle trim **AT125**
- G** Joint trim **JT125**
- H** Drip trim **DT125**
- I** Cladding pins (available in 25mm and 30mm sizes) **CP25 / CP30**

Examples of use



Always start the installation at the base, creating a level situation before fitting a starter trim.



Two-part edge trim to finish a cladding cut back on its length to accept the expansion of the board



Two-part angle trim for both internal and external corners



Two-part edge trim to finish of the last plank



Joint trim



Butt joint trims can be used instead of joint trims providing they are staggered and fitted where a batten is located

Fixing instructions

Please note:

Cladding should always be affixed to battens

- 1** Shiplap cladding should be fitted to preservative treated 38mm x 25mm soft wood tanellised battens
- 2** Fix battens vertically at 600mm centres. If fitted in exposed areas, ie high rise flats, reduce centres to 400mm
- 3** When thermal insulation is required, a 20mm air gap must be provided thus necessitating cross battens. If cladding is fitted to stud work or subject to extreme weather conditions, a breather membrane should be used between cladding and the substrate
- 4** Always start the installation at the base, creating a level situation before fitting a starter trim (see Diagram 1)
- 5** Before fitting the cladding, complete trim preparation by fitting edge trim, corner trim and joint trim where required. All trims are secured to a batten network with a double batten required for the joint trim (see Diagrams 2 - 5)
- 6** For trimming around windows, use a two-part edge trim beneath and to the sides, and a drip trim at the window head to ensure no build up of water (see Diagram 6)
- 7** On the white shiplap cladding, cut back 5mm per edge to allow for expansion behind the edge, corner and joint trims. For laminated shiplap cladding, allow 8mm per edge
- 8** The shiplap cladding is secured by nailing the flat-headed 30mm stainless steel cladding pin into the nail groove. Always secure the first nail at the centre and work towards the outer edges.
- 9** Due to Eurocell's deep tongue and groove design, any irregularities in levels can be made up by slightly raising each plank
- 10** The last (top) plank might not finish as a complete board and if this is the case use packing pieces from off cuts to keep the vertical datum line level (see Diagram 7)
- 11** When shiplap cladding is nailed into position, simply snap home the front part of the two-part edge trim for a neat finish (see Diagram 7)
- 12** If butt joint trims are used instead of centre joint trims they should be staggered per length and positioned where a vertical batten is located. Again a 5mm gap per side should be left allowing the butt joint trim to be located. When snapped into position, one side should be left glued, with the other free for expansion. Please allow an 8mm gap for laminated shiplap cladding (see Diagram 8)

Fixing diagrams

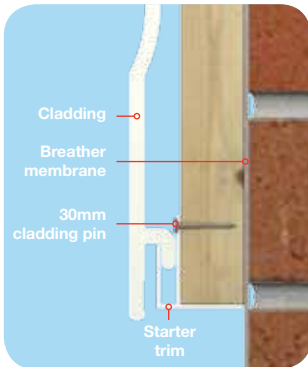

Diagram 1
Shiplap cladding featuring the starter trim affixed to batten. To be fitted to a maximum of 600mm centres

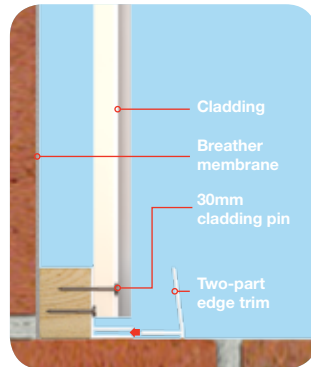

Diagram 2
PLAN VIEW - showing shiplap cladding secured by two-part edge trim allowing for a 5mm expansion gap

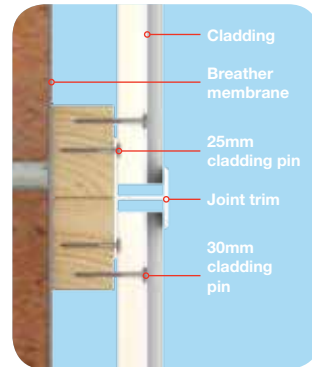

Diagram 3
PLAN VIEW - showing shiplap cladding featuring the panel joint for connecting 2 x 5m lengths together again, allowing for 5mm expansion gap either side

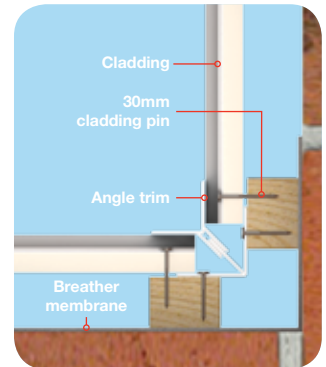

Diagram 4
PLAN VIEW - showing shiplap cladding fixed into a two-part internal angle trim. The cladding needs reducing by 5mm to allow for any expansion

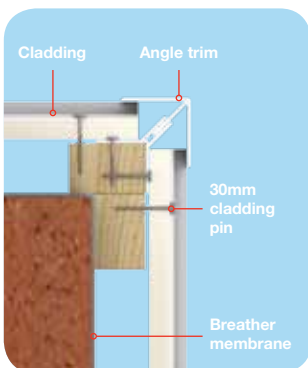

Diagram 5
PLAN VIEW - showing shiplap cladding fixed into a two-part external angle trim. The cladding needs reducing by 5mm to allow for any expansion

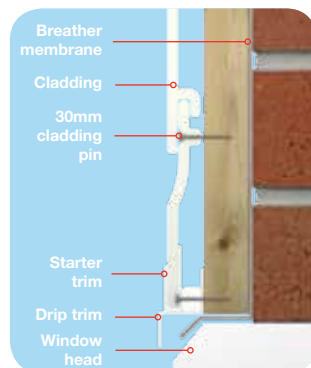

Diagram 6
Shiplap cladding incorporating the drip trim and cut down starter trim over the top of a window head. A packing piece has also been used

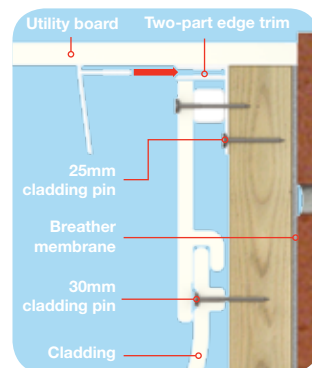

Diagram 7
Cut down shiplap cladding finished with two-part edge trim on the underside of soffit detail. A packing piece has also been used



Diagram 8
For continuous runs, a butt joint connects the cladding. This is staggered per length and positioned where a vertical batten is located

Please note:

Cladding should **always** be affixed to battens.

Foiled and laminated boards should be fitted in lengths of **2.5m maximum**, to accommodate the expansion requirements, especially on south facing elevations.

Roof ventilation and eaves protection



Configure your roofline for optimum ventilation results with our range of ventilators and accessories



Disc ventilators

Your roofline solution can be further enhanced by various add-ons which help improve ventilation and prevent birds from getting into roof spaces.

Our 70mm disc ventilators can be installed onto soffits to offer additional airflow in roof spaces. These are available in White, Black and Oak finishes.



Over-fascia ventilation

The over-fascia ventilation products supplied by Eurocell are easily installed, providing exceptional eaves ventilation for all new-build or re-roofing projects. They are available in 0.9m and 1m lengths and 10mm and 25mm depths, delivering varying ventilation capacities.

When installed along the whole length of the eaves, the 10mm vent provides the equivalent of a continuous 10mm opening (10,000mm² per metre run), while the 25mm vent provides the equivalent of a continuous 25mm opening.

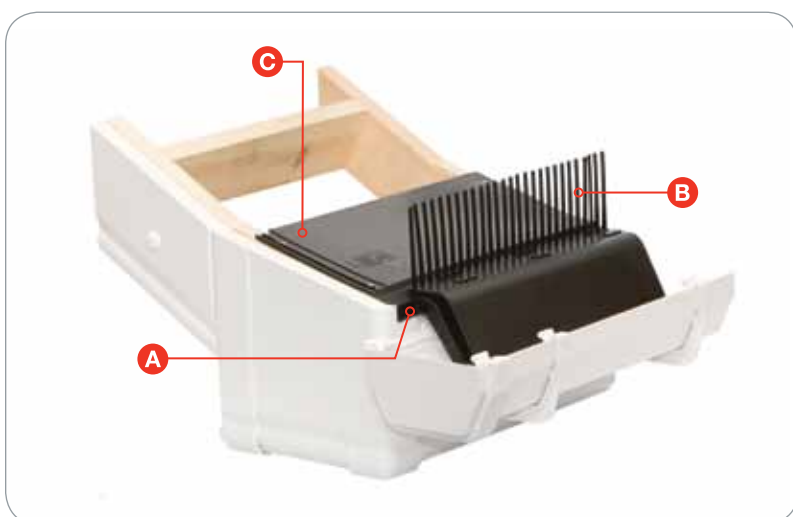

3-in-1 solution

In addition to these individually available items, there is a 3-in-1 solution (as shown left) which combines:

- A** Over-fascia ventilation which sits underneath the felt tray
- B** Eaves comb filler
- C** In-built felt tray which prevents the roof felt from sagging and allowing pools of water to form

Rainwater systems



We offer a complete range of PVC-U rainwater systems and accessories, with effective, robust and attractive plastic gutters and downpipes manufactured by Marshall Tufflex



Square-line guttering



Half-round guttering



Universal plus guttering



Universal XL guttering

Accreditations

Rainwater systems are manufactured to comply with the requirements of BS EN 607:1996; BS EN 1462-1997; EN 12200-1:2000; BS 4576-1:1989 (where applicable)



Colour options

See overleaf

We offer a complete range of PVC-U rainwater systems and accessories, with effective, robust and attractive plastic gutters and downpipes manufactured by Marshall Tufflex, which are suitable for all types of domestic and commercial property.

We supply half-round guttering ideal for most replacement projects, as well as square-line guttering for something a little different – complete with adaptors for compatibility with existing PVC-U systems. Ogee guttering provides a highly decorative, sculpted alternative and we also supply commercial plus and universal plus guttering for large roofs on bigger homes or commercial properties where higher capacity is required.

All styles come complete with a full range of matching accessories and fitting systems and offer an exact colour match with our roofline products. Cream-coloured guttering is available exclusively from Eurocell, providing an exact colour match with our roofline products for a unique solution.

Our guttering is manufactured from high-impact, high-gloss PVC-U for a long-lasting, weather-proof finish. The easy-click fitting system makes it fast and simple to install and all guttering comes with a ten-year quality and colour fastness guarantee*.

What's more, our high-capacity systems require fewer downpipes, improving the appearance of any property. All outlets are designed for maximum flow capacity to avoid back up in the gutter, preventing overflow in heavy rain.

* Applicable on White systems only



Colour and usage options Quick reference

System and size

Usage



System and size	Usage	White	Black	Grey	Brown	Clay brown	Cream
Half-round system 114mm x 51mm	Residential	✓	✓	✓	✓	×	×
Square-line system 114mm x 59mm	Residential	✓	✓	×	✓	×	×
Universal XL system 114mm x 71.5mm	Large residential Light commercial	✓	✓	×	✓	×	×
Universal system plus 128mm x 88mm	Terrace housing Community housing Conservatories	✓	✓	×	✓	✓	✓



Half-round guttering

The classic, widely used half-round guttering style is ideal for residential buildings of all types. It is an easy-clip design with rounded ends for quick and simple installation. The guttering is 112mm wide and is available in 2m and 4m lengths, with a host of brackets, adapters and accessories to complete the job. Half-round guttering from Eurocell is compatible with most other systems and is guaranteed for durability and colour-fastness.

Square-line guttering

The stylish, contemporary square-line guttering style is suitable for all residential building applications. The guttering is available in 2m and 4m lengths, with a host of brackets, adapters and accessories to complete the job. It is 114mm wide and 59mm deep.

The square-line system has an easy-clip design with rounded ends for quick and simple installation. Top-hung fascia brackets are available to give a smoother look to your roofline. Square-line guttering is guaranteed for durability and colour-fastness.

Universal guttering

Universal guttering is a robust, high-capacity guttering system designed for

use on larger residential and commercial buildings. It is available in 4m lengths, with a host of brackets, adapters and accessories to complete the job. Universal guttering is guaranteed for durability and colour-fastness. It is available in two styles to suit different types of building:

Universal Plus (128mm x 88mm)

Designed for use on large residential buildings, smaller commercial premises and conservatory roofs. It has an aesthetic appearance to complement any type of property. The system features soft rubber gaskets with deep ribbing and holding clips that exert extra pressure on the gaskets for improved rigidity. The system is durable and sturdy due to the thick PVC-U gutter extrusion.

Universal XL (114mm x 71.5mm)

A rainwater system for properties with a large roof area, such as terraced housing and commercial buildings. The deep elliptical shape is designed to handle high rainwater volumes. Such a high-capacity system means that fewer downpipes are required, improving the look of a property and allowing more space for windows or wall designs. The system can be installed quickly and easily, and running outlets are compatible with either square or round downpipes.

Fixing instructions

NOTE - All installations must conform to Building Regulations.



Diagram 1

The procedure for gutter fixing is dependent upon the design chosen, i.e. End or Centre Outlets for houses with standard gable ends, and a combination for hipped roof buildings. In all cases the Outlets should be positioned directly above the gully or drain connection if at all possible. Before installation, check that fascia boards etc. are level, and make allowances if not, when determining gutter fixing positions.

1
Fix the two End Support Brackets as high as possible under the roof tiles (as per Building Regulations), making allowance for the fixing of an External Stop End. This may be under the tiles or extending 40mm beyond the end tile, depending on the gable end design. These brackets must be fixed with a 25mm no.10 rust proof round head screw (brackets are designed for fixing with one or two screws). See Diagram 1.

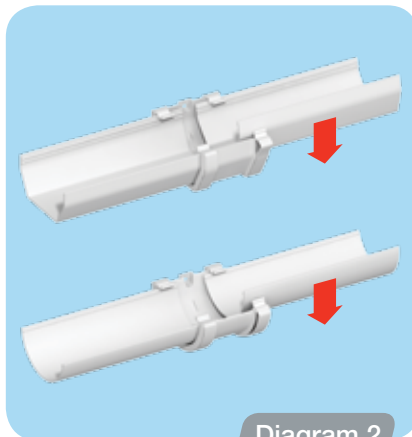

Diagram 2

2
The Running Outlet is then fixed, at a level below the End Bracket. The gutter should have 1 1:600 fall, and so the Outlet should be positioned to allow for a fall of 25mm in every 15m run of gutter. This Outlet is fixed with similar screws. See Diagram 1.

3
If the building does not have a fascia board then special brackets can be used to fix the gutter to the rafter or directly into the masonry.

4
For intermediate supports (fascia brackets), draw a string line between the End Brackets and the Outlet and fix the intermediate Brackets at the appropriate spacings.

Top hung fascia brackets should be spaced at 600mm for Universal System Plus.

Conventional style brackets should be spaced at a minimum of 800mm for Universal System Plus / Universal XL and a maximum of 1 metre for Half Round / Square Line Systems.

On conservatory roofs the fascia bracket spacing should be reduced to 500mm to take into account snow loads.

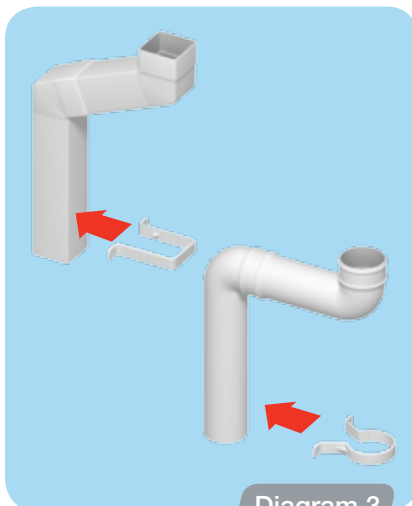

Diagram 3

5
Where the gutter run is over 4m, the Union Brackets should be carefully positioned at this time being sure to allow

for expansion and contraction. The Union Brackets must be fixed with a 25mm no.10 rust-proof round head screw.

6
When fixing gutter into Union Brackets. Outlets etc, secure the back edge of the gutter under the rear of the clip, pull the front edge of the gutter down and push the loose clip over the front edge with your thumbs until it snaps into position. The ends of the gutter should line up with the insertion marks on the fittings to allow for movement. See Diagram 2.

7
Where the gutter is taken around corners, the corner angles need to be supported by fascia brackets positioned within 75mm of the angle for Universal System Plus / Universal XL and within 300mm for Half Round / Square Line Systems (Universal Plus corners also have fixing ports that should also be fixed using rust-proof screws). Marshall Tufflex recommend the use of lubricant on all gutter seals for ease of fitting and for improved performance.

8
When fixing the Downpipe you will almost certainly need to form an offset bend using 112° Offset Bends and a length of pipe or where space is short two 90° Bends. These Bends are designed to 'grip' into each other, however the use of a small collar may be required when connecting to the running outlet. The bottom of the Bend is held in position with a Downpipe Clip. If a narrow offset is required when using the square downpipe, the RWSB4 Adjustable Offset can be used. See Diagram 3.

9
When fixing a Downpipe, a Downpipe Clip should be used at each socket connection and at a maximum 2m spacing between. An 8mm gap should be left at the top of each section of pipe to allow for expansion.

10
The water enters the drain through either a Shoe and Gully, or using the underground drainage adaptor direct into the 110mm drain.

11
The Downpipe Shoe, where used, should be supported by a Downpipe Clip to prevent the shoe from dropping.

Dry verge

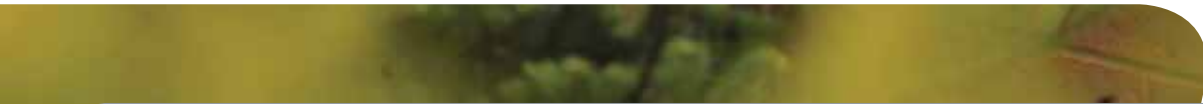

PVC-U dry verge is the perfect no maintenance, weather-proof and pest-proof finishing touch to any tiled roof

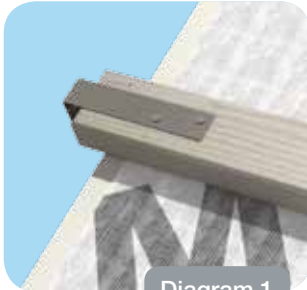

Diagram 1

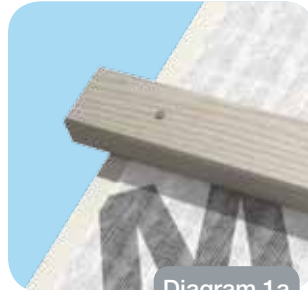

Diagram 1a



Diagram 2

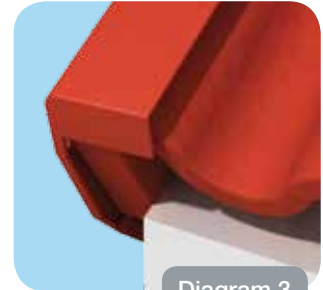

Diagram 3

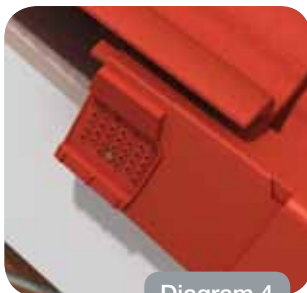

Diagram 4

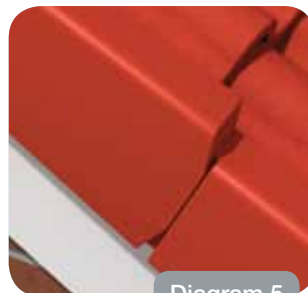

Diagram 5



Diagram 6



Diagram 7

Colour options

Standard colour options and finishes:



White

Terracotta

Brown

Slate Grey

Black

PVC-U dry verge is the perfect no-maintenance, weather-proof and pest-proof finishing touch to any roof, specially designed to neaten up roof edges and block any gaps that could allow infestation of the roof space. It can be retrofitted to existing buildings to tidy roof edges and cover any unsightly gaps, as well as being ideal for the new-build sector. It's a mortar-free solution that's simple to fix, avoiding the need for wet trades.

Our PVC-U dry verge is compatible with most concrete or clay interlocking tiles and comes in four colours to complement every home. Your local Eurocell Building Plastics branch sells everything you will need to complete your dry verge installation. The simple, secure clip fixing system makes it easy to install and avoids the problem of wind uplift.

Fixing instructions

1 Extend the tiling battens 20mm beyond the gable wall or barge board and nail a Batten End Clip to the end of every batten.

1a If a batten end clip is not being used we recommend that the batten is extended 30mm over the barge board or brickwork and 40mm (minimum) x 3.25mm ring shank nails are used to fix the verge units. Prior to fixing the batten ends must be in good condition with no signs of decay or splitting.

2 Fix the Eaves Closure to the end of the fascia board or brick work.

3 Fit the first verge section ensuring that it is located onto the eaves closer.

4 Nail in position, through the Batten End Clip into the batten.

5 As each successive verge tile is laid, slide on a Dry Verge unit up to the tile toe, engaging with the unit below, nail in position through the Batten End Clip into the batten.

6 Insert a Ridge Closure into the last Unit, interlocking the combs of each Dry Verge unit at the apex.

7 Screw fix the Ridge End Cap to the ridge batten.

RETRO FIT If dry verge units are to be fitted to existing buildings all of the old under-cloak and mortar bedding should be removed prior to fixing. A timber batten can then be installed running from the eave to ridge, this batten should protrude 30mm over the barge board or brick work / render for the units to fix into (as per step 1a).

Compatibility

Our dry verge suits most concrete and clay interlocking tiles between 280mm and 345mm batten gauge.

Finishing trims and fixings

Roofline and windows



All Eurocell fascias, soffits, window and door systems are complemented by our vast selection of high-quality PVC-U fixings, trims and finishing touches. You can rest assured that everything you need to complete every job is available from your local Eurocell branch - with free next-day delivery

Roofline trims and fixings

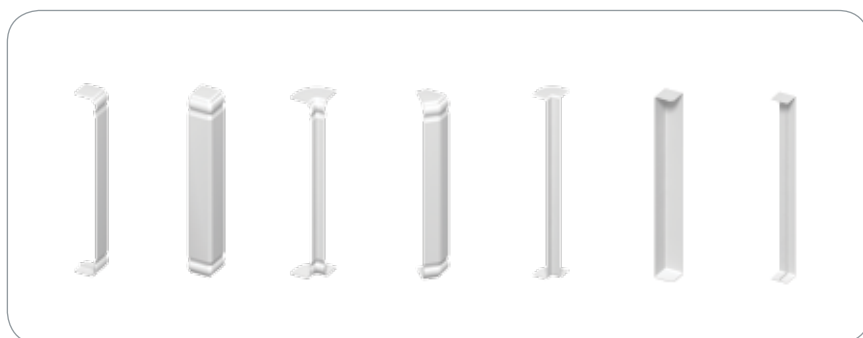

Roofline finishing trims and accessories

We offer full range of joint trims, corner trims, angle trims, edge trims, finials, ventilators for use with our fascia and soffits. For a full look at our product offering, go to page 50



Roofline fixings

Eurocell offers fixing pins, fixing nails and capping screws in matching colours to our fascia and soffits

Colour options

Standard colour options and finishes:



Note: Not all roofline finishing trims are available in the full range of colours above. For a comprehensive colour availability checklist for each product, see page 61.



White roofline installation featuring finishing trims

All our trims and extras are fully compatible with our range of PVC-U products and are designed to add the perfect finishing touches to any roofline project. You are also guaranteed an exact colour match with all of our PVC-U products.

Window finishing trims - internal use



6mm pencil round architrave (flatback) in Rosewood



D mould as a joint between two windows



Foam quadrant in Golden Oak finish



9mm capping board used as a reveal liner

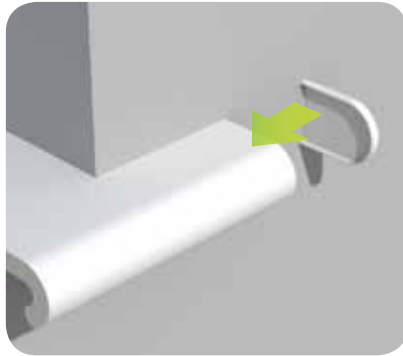

9mm window board with end cap

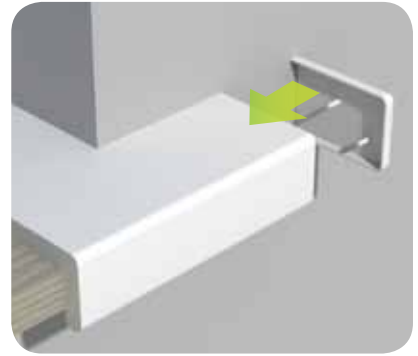

9mm capping board with end cap, used as an internal window cill

Colour options

Standard colour options and finishes:



Note: Other colours also available. For a comprehensive colour availability checklist for each product, see page 61.

We offer a full range of architraves, quadrants, cloaking fillets, window board end caps, drop-nose and bull-nose window boards and cills.

See pages 50 - 52 for the full range and measurements

Architraves

Where plaster damage is minimal, the foam architraves are available in either 6mm or 9mm thickness. These trims can be fixed with adhesive tapes or silicone, with the latter needing support until it has cured.

Window finishing trims

Similar to the architraves, these products offer an alternative finishing option around the windows.

Window boards

Available in a 9mm thickness, a capping or window board provides a square or half round finish. These products can be secured to existing window boards by using an adhesive.

Window cills and accessories - external use

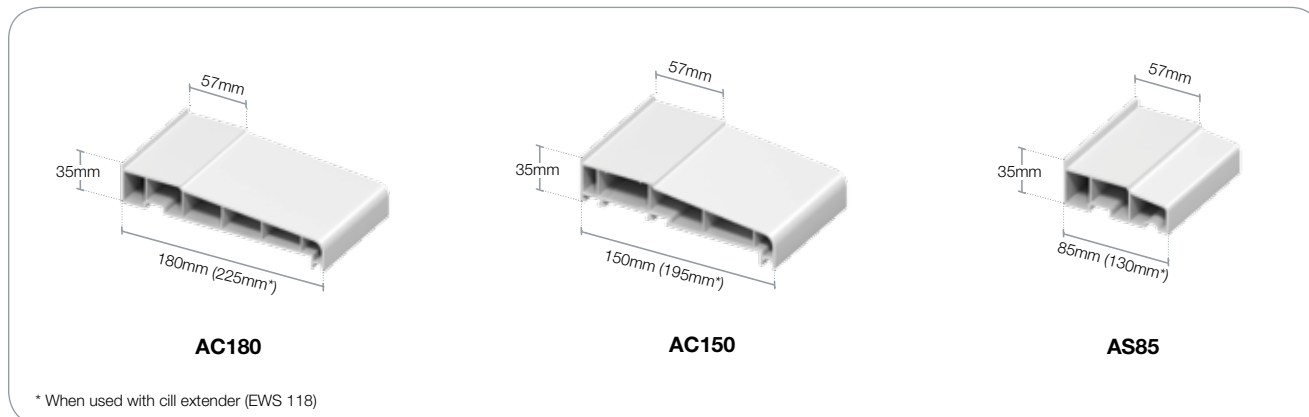

Cills

Eurocell window cills come in 85mm, 150mm and 180mm widths, and we also offer cill extenders and reinforcements. See page 60 for the complete range, colour options and relevant measurements

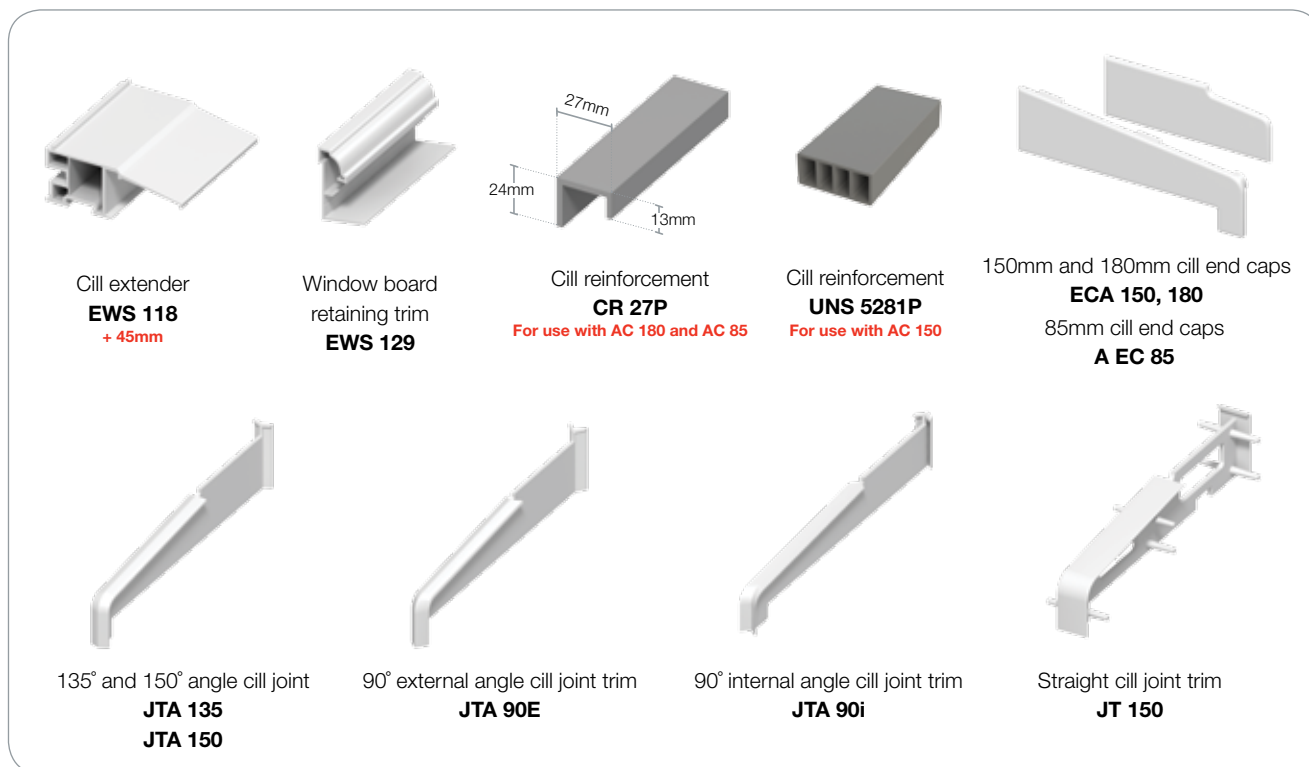

Joints, trims and reinforcements

Eurocell offers matching end caps and a full range of joint and angle trims. See page 60 for the complete range, including colour options

Roomline

PVC-U skirting boards and architraves



Roomline PVC-U skirting boards and architrave system are simply better – no preparation, no painting, no problem!



Skirting boards

Ideal for domestic and commercial applications, sculpted Roomline boards have all the looks of timber, complete with realistic woodgrain finishes. An ideal finish to any room.

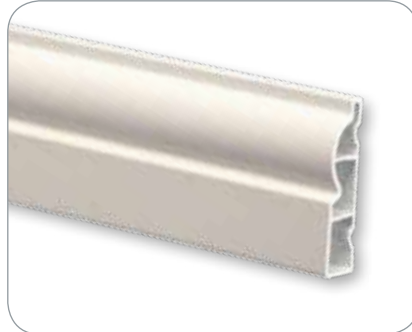

Architrave

Designed to perfectly complement the Roomline skirting boards, these architraves are decorative door surrounds to add the finishing touch to any room.



Trims

Skirting boards simply slot together with the help of pre-moulded corner pieces (internal and external) – removing the need for mitring!

Colour options

Standard colour options and finishes:

Roomline skirting boards and architraves will enhance any home and are available in colours to suit all tastes.



White Satin

Rosewood

Golden Oak

English Oak

Sizes

Skirting boards

100mm high x 15mm deep x 5m long
100mm high x 15mm deep x 2.5m long

Architraves

60mm wide x 15mm deep x 5.5m long

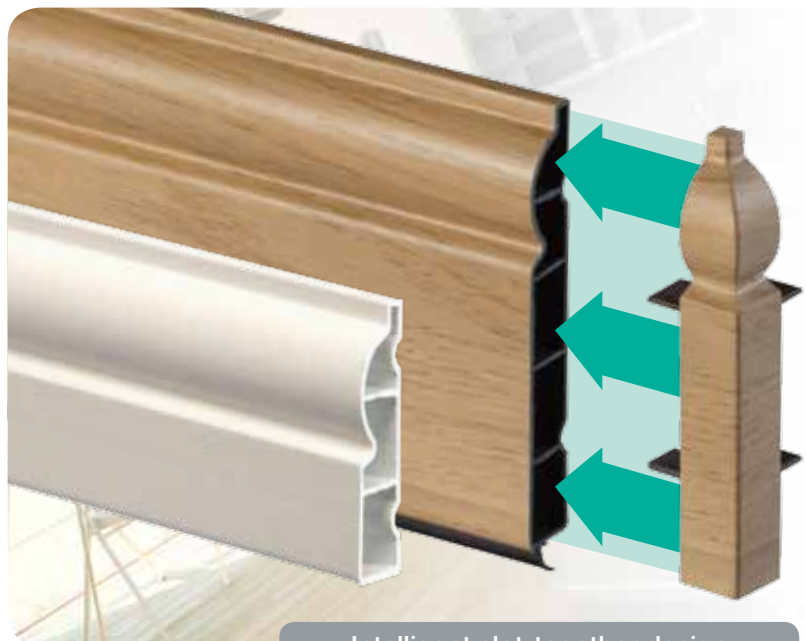

Intelligent slot-together design

Skirting boards are both decorative and practical. They hide the junction between the wall and the floor but also protect against inevitable everyday knocks from shoes, vacuum cleaners and kids toys. With Roomline you get all the tough, hard-wearing, wipe-clean benefits of PVC-U, with all the aesthetics of traditional skirting boards and architraves.

Roomline PVC-U skirting boards and architraves are the ultimate no-hassle, no-maintenance, easy-fit and cost-effective way to add the essential finishing touches to any room. Ideal for new build or refurbishment, the Roomline system has all the looks of timber – with none of the hassle.

Skirting boards fixing diagrams

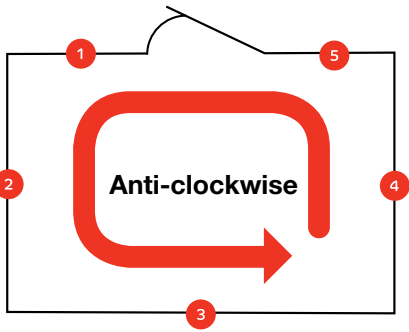

Please note:

If you are planning to lay a new laminate or tiled floor, do this **before** fitting the skirting board for the neatest finish

If you are carpeting, fit the skirting boards **first**

Always fit Roomline skirting boards from the door opening in an **anti-clockwise** direction

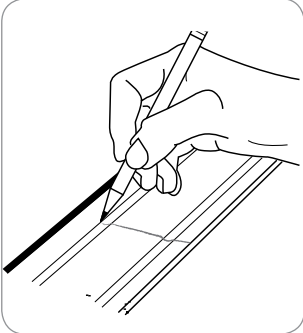

Figure 1

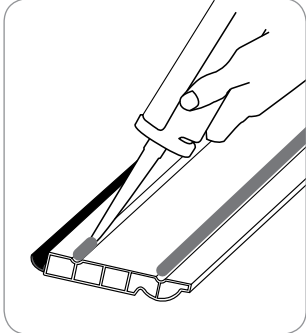

Figure 2

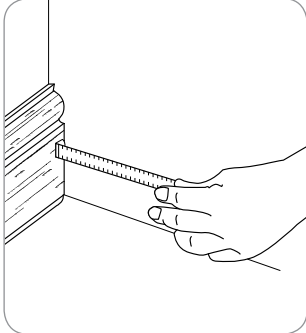

Figure 3

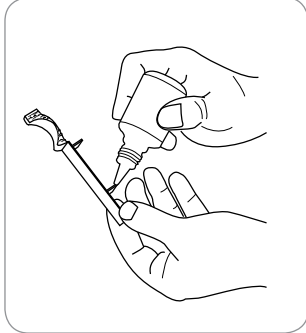

Figure 4

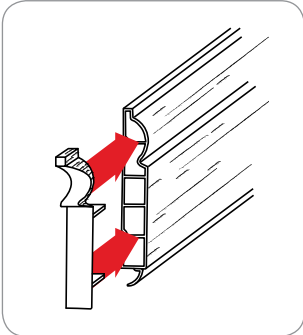

Figure 5

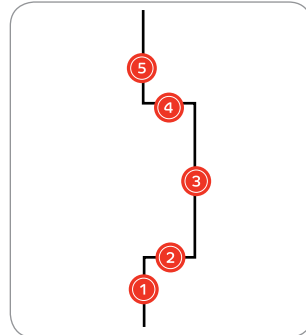

Figure 6

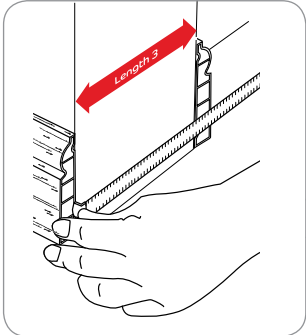

Figure 7

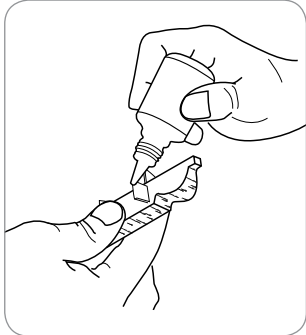

Figure 8

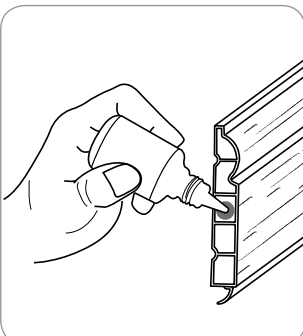

Figure 9

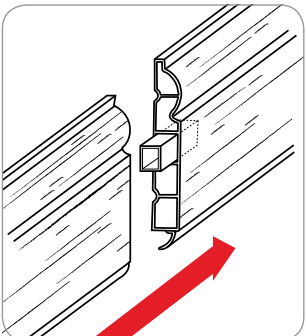

Figure 10

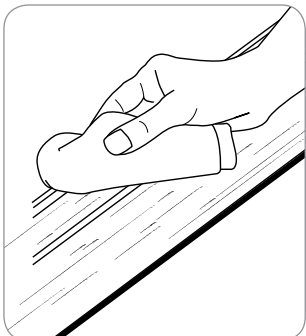

Figure 11

Skirting boards fixing instructions

1. Fitting

1.1

Measure length 1 from the external edge of the architrave to the inside corner of the room. Transfer this measurement onto a length of skirting board and mark accurately with a pencil. Cut the skirting board to length using square cuts with the aid of a fine toothed saw and saw block. Position the skirting board to check length. *See Fig 1*

1.2

Lay the skirting board on its face and apply a bead of SilverSil Never Nails or another contact building adhesive down each adhesive channel. Place the skirting board in position pushing firmly back to the wall. *See Fig 2*

1.3

Measure length 2 from the flat face of the skirting board to the inside corner of the room. Cut to length using square cuts. *See Fig 3*

1.4

Apply contact adhesive to the scribed internal corner moulding (available from your local Eurocell Building Plastics branch as part of the corner trim kit) and push onto the left hand end of the cut skirting board. Position the skirting board to check for length and trim if necessary. Once satisfied repeat stage 2. *See Fig 4*

1.5

Repeat this process until the room is complete.

2. External corners

See Figure 6 for example

2.1

Measure from the flat face of skirting board 1 to the external corner of the wall. Cut the skirting board using square cuts. Fit a scribed internal corner moulding to the left hand end and check for fit. If satisfied fix in position with adhesive. *See Fig 5*

2.2

Measure length 4 from the inside corner of the room to the external corner of the room. Cut to length using square cuts. If satisfied with fit fix to wall using adhesive.

2.3

Measure length 3 from the inside faces of fitted lengths 2 & 4 and square cut to length. *See Fig 7*

2.4

Apply adhesive to the external corner mouldings and push fit onto each end of length 3. Apply adhesive to the back face of the skirting board and the remaining tabs of the corner mouldings and fix into position making sure that the tabs locate into their correct position within the previously fitted lengths 2 & 4. Wipe off any surplus adhesive. *See Fig 8*

3. Inline joints

3.1

Cut the required lengths of skirting board to be jointed with accurate square cuts. Apply adhesive into the correct cavity of one cut length. *See Fig 9*

3.2

Push fit the in-line joint moulding so that half the moulding is inside the skirting and half protrudes. *See Fig 10*

3.3

Apply adhesive into the other length to be jointed and push fit onto the moulding until a tight fit is achieved. Wipe off any excess adhesive. Once jointed the length can be fitted in the conventional manner.

4. Maintenance

4.1

Roomline products are designed for minimal maintenance. All they require is the occasional wipe over with household polish or a damp cloth. Stubborn marks can be removed using a non abrasive cream cleaner, such as SilverSil Cream Cleaner. The use of chemical based cleaners or abrasive materials is NOT recommended. *See Fig 11*

Architraves fixing diagrams

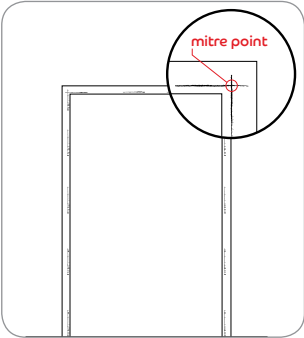

Figure 1

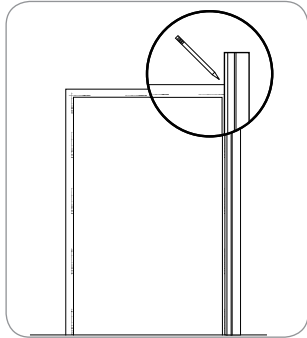

Figure 2

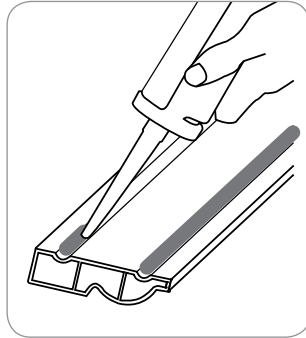

Figure 3

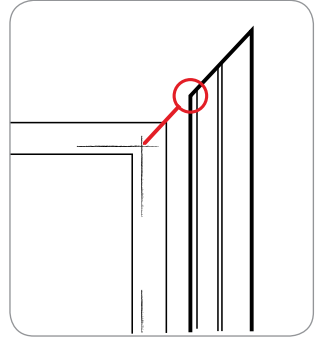

Figure 4

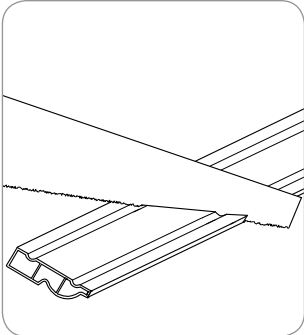

Figure 5

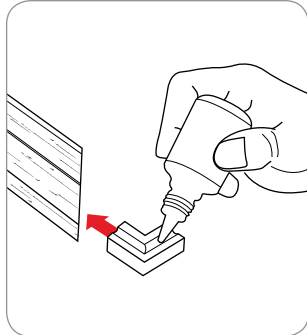

Figure 6

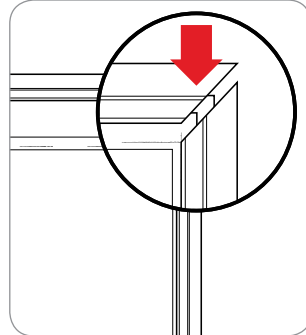

Figure 7

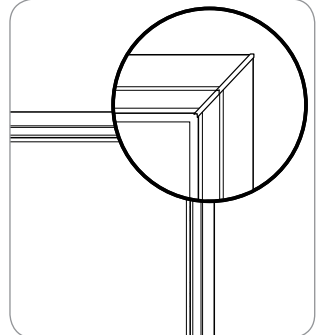

Figure 8

Architraves fixing instructions

Architraves are decorative trims that are fixed around an internal door, window or loft hatch openings which hide the unsightly joint between wall and timber casing. To cover one side of a door casing there are 3 lengths (a set), one horizontal head piece and 2 vertical legs or jambs.

When fitted, architraves are usually set back from the edge of the door casing between 5-7mm, this is known as the margin. A margin provides a neat appearance around the door opening.

1. Fitting

1.1

After you have decided what margin you require on the door, carefully mark the door casing with short margin guidelines at this dimension. *See Fig 1*

1.2

Extend the lines at each head and jamb intersection so that they cross. This will determine the architrave mitre point.

1.3

Offer up the first length of architrave jamb making sure it follows the vertical margin guidelines. Mark the inside face of the architrave where the two guidelines cross. Repeat this for all 3 lengths. *See Fig 2*

1.4

Cut the first architrave at 45° using a mitre block and fine toothed saw, use the marked pencil line as a guide.

1.5

Lay the cut architrave face down on a flat surface and apply a bead of SilverSil Never Nails or another suitable contact adhesive down the two adhesive channels. *See Fig 3*

1.6

Position the architrave on the wall making sure it follows the vertical margin guidelines. *See Fig 4*

1.7

Repeat steps 4 to 6 for the other side of the door jamb.

1.8

Cut the head section to length using the previously marked lines. Each end is cut at 45°. *See Fig 5*

1.9

Apply a small amount of contact adhesive to each corner guide moulding and push fit into each end of the cut architrave. Apply adhesive down each channel of the architrave. *See Fig 6*

1.10

Carefully position the head section in place ensuring that the corner guide mouldings locate into the vertical jamb sections. Remove any excess adhesive. *See Fig 7*

1.11

If for any reason the mitre joints don't line up correctly, mitre joint covers are supplied (only supplied with the single door kits. For architrave lengths, joint covers are available separately in the trim kits from your local Eurocell Building Plastics branch). These should be glued in position to cover any gaps. *See Fig 8*

2. Maintenance

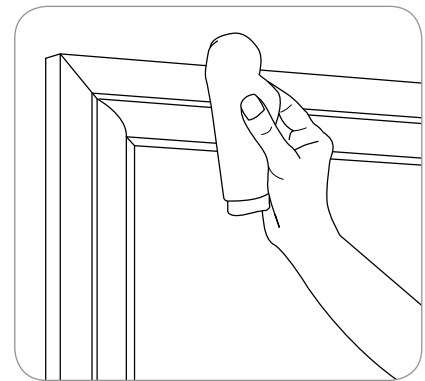

2.0

Roomline products are designed for minimal maintenance. All they require is the occasional wipe over with household polish or a damp cloth. Stubborn marks can be removed using a non abrasive cream cleaner, such as SilverSil Cream Cleaner. The use of chemical based cleaners or abrasive materials is NOT recommended.

Composite doors



The Dales Collection of composite doors brings style, high security and long-life performance direct to your doorstep. Behind its classical appearance, you'll find the most advanced engineering, design and technology for entrance doors



Middleton Hathersage Bradbourne Brassington Chatsworth Cromford Winstar Wirksworth Thorpe Pilsley

Accreditations



Official Police Security Initiative
Association of Chief Police Officers' Secured By Design



PAS 23 / 24
(Certificate number KM500319)
Specification for general performance requirements / enhanced security performance of door assemblies



Q Mark
BM Trada Q Mark accredited, for enhanced door security

Colour options

Standard colour options and finishes:

Our stylish doors are available in colours and styles to suit all tastes:



Note: All doors are Frost White internally as standard. Rosewood and Golden Oak is available on both sides if required



Features and benefits

- ▶ 10 stunning styles from traditional to contemporary, available in 7 colours for greater choice
- ▶ Selection of quality stainless steel door furniture with a choice of colour options, covered by a 25-year guarantee
- ▶ Triple-seal frame system ensures doors remain watertight even in the harshest weather conditions
- ▶ 3-way adjustable hinges mean they are quick and easy to install, saving you time and money
- ▶ Optional aluminium low-threshold
- ▶ PAS 23/24 for improved security as standard
- ▶ Association of Chief Police Officers' Secured by Design approved (subject to specification)
- ▶ BM Trada Q-mark achieved
- ▶ DERs are B-rated doors as standard. A-rated available – ask for more details



Range of sizes and styles

The Dales Collection of composite doors from Eurocell offers you the most advanced engineering, design and technology for front or back entrance doors. With a choice of ten styles in seven colours and attractive glazing options, the Dales Collection offers a door to suit every home – from contemporary chic to traditional Edwardian or quaint cottage-style.

Unrivalled security

Our composite doors feature the latest multi-point locking technology for maximum security. Plus, Dales Collection doors and locks have been through rigorous tests which have earned them the approval of the Association of Chief Police Officers' Secured by Design scheme* and the Police Preferred Specification PAS23 & PAS24.

Superior thermal efficiency

A glass reinforced plastic (GRP) outer skin around a panel insulated with rigid foam means that our composite doors retain up to six times the heat of a timber door, keeping energy bills down. Plus, PVC-U Thermal Inserts in the frame offer improved energy efficiency and enhanced sustainability.

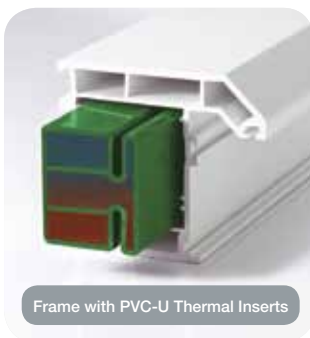

Frame with PVC-U Thermal Inserts



High-security cylinder lock

Low maintenance design

The GRP door leaf means there is no risk of splits or cracks. This outer skin is also less prone to scratching and denting than steel-faced doors.

Outstanding all-weather performance

A high-quality triple-seal frame system means that composite doors give outstanding performance for many years. Two brush seals and a gasket seal mean that drafts and rain are kept out, even in the fiercest weather conditions.

Easy installation

Composite doors are designed for simple, rapid, yet high-quality installation. They incorporate fitter-friendly three-way adjustable hinges and a wide frame for deep plaster reveals.

Accessible for all

Accredited low-level aluminium thresholds are available for Part M Building Regulations compliance, offering easy access for wheelchairs and pushchairs. The Eurocell composite door range is the ideal front door for those seeking easy access without compromise on style or performance.

Colour-matching

The Dales Collection doors are also available with colour-matched weather bars (except Golden Oak and Rosewood).



*Subject to specification. Ask for more details

Min / max size information All measurements in mm. Sizes include outerframe. Sizes do not include cill, extensions etc

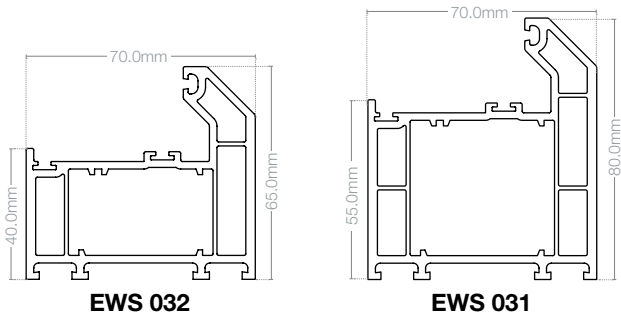

Choose from two different outer frames.

All measurements in mm.
 Sizes include outerframe.
 Sizes **do not** include cill, extensions etc
 Cill will increase door height by 30mm

Doors with EWS 031 outerframe

Door style	Width		Height (all low-threshold)		Height (PVC-U bottom)	
	Min	Max	Min	Max	Min	Max
Bradbourne	860	1012	1979	2089	2021	2130
Chatsworth	860	1012	1979	2089	2021	2130
Cromford	860	1012	1979	2089	2021	2130
Hathersage	860	1012	1979	2089	2021	2130
Wirksworth	835	1012	1979	2089	2021	2130
Pilsley	860	1012	1979	2089	2021	2130
Winstar	860	1012	1979	2089	2021	2130
Brassington	835	1012	1979	2089	2021	2130
Middleton	835	1012	1979	2089	2021	2130
Thorpe	835	1012	1979	2089	2021	2130

If door has GRP side panel and an aluminium low-threshold, **min height = 2020**. All heights are **reduced by 3mm** if open out aluminium low-threshold

If door has GRP side panel and PVC-U bottom, **max height = 2121**

GRP side panels

Min width	Max width	Height
410	475	To suit door

All side lights are separate.
 Sizes include outer frame and coupler

Top lights

Transom height from bottom of door

Aluminium low-threshold		PVC-U bottom	
Min	Max	Min	Max
1945	2054	1986	2095

Dimensions to centre of transom. Doors over 2500mm will have separate top lights

Doors with EWS 032 outerframe

Door style	Width		Height (all low-threshold)		Height (032 full outer)		Height (031 threshold)	
	Min	Max	Min	Max	Min	Max	Min	Max
Bradbourne	830	982	1964	2074	1991	2100	2006	2115
Chatsworth	830	982	1964	2074	1991	2100	2006	2115
Cromford	830	982	1964	2074	1991	2100	2006	2115
Hathersage	830	982	1964	2074	1991	2100	2006	2115
Wirksworth	805	982	1964	2074	1991	2100	2006	2115
Pilsley	830	982	1964	2074	1991	2100	2006	2115
Winstar	830	982	1964	2074	1991	2100	2006	2115
Brassington	805	982	1964	2074	1991	2100	2006	2115
Middleton	805	982	1964	2074	1991	2100	2006	2115
Thorpe	805	982	1964	2074	1991	2100	2006	2115

If door has GRP side panel and an aluminium low-threshold, **min height = 2005**. All heights are **reduced by 3mm** if open out aluminium low-threshold

If door has GRP side panel and PVC-U bottom, **max height = 2091**

032 is **15mm smaller** on both faces

GRP side panels

Min width	Max width	Height
410	475	To suit door

All side lights are separate.
 Sizes include outer frame and coupler

Top lights

Transom height from bottom of door

Aluminium low-threshold		PVC-U bottom	
Min	Max	Min	Max
1945	2054	1971	2080

Dimensions to centre of transom. Doors over 2500mm will have separate top lights

Door measurements Example shows EWS031 outerframe

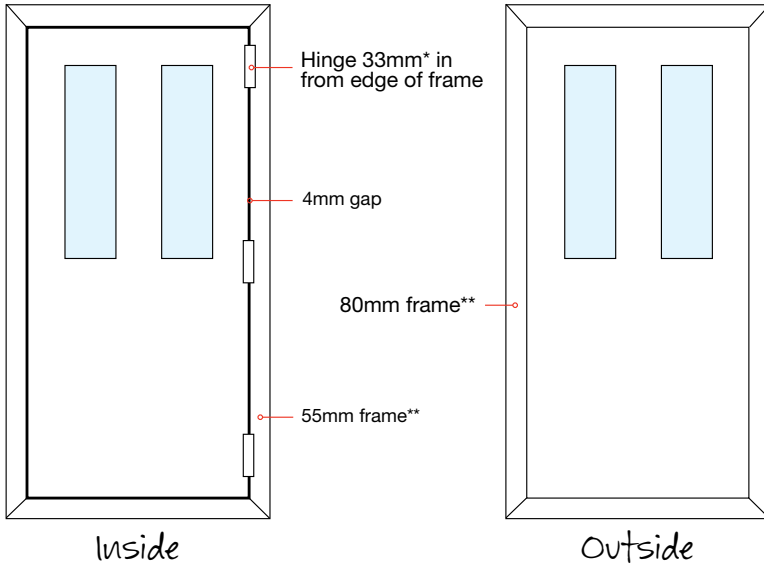

* When using EWS032 frame, hinges are set 18mm in from the edge of the outer frame

** When using EWS032 frame, sizes are 15mm smaller on both internal and external faces

Interior door leaf

Leaf width = overall door width less 118mm

Exterior door leaf

Opening width = overall door width less 180mm

When open at 90°, the door edge protrudes 20mm into the opening

Glazing sizes All units 4/16/4 toughened

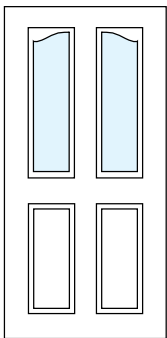

The Bradbourne
Right and left eyebrow cassette
203mm x 912mm

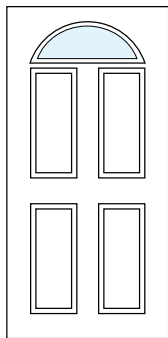

The Brassington
Half moon cassette
R279mm x 250mm

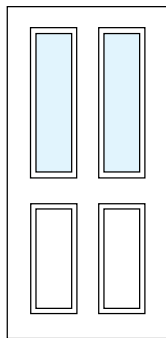

The Chatsworth
Twin vertical cassette
203mm x 912mm

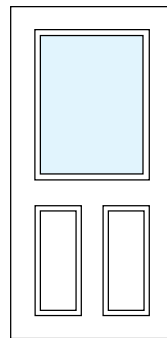

The Cromford
Half glazed cassette
558mm x 912mm

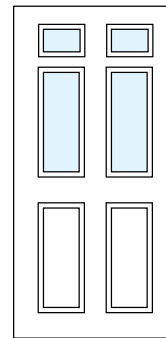

The Hathersage
Twin top cassettes
202mm x 152mm
Mid panel cassettes
202mm x 578mm

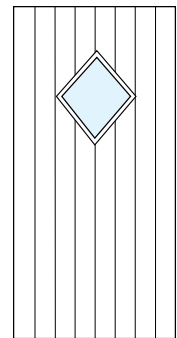

The Middleton
Diamond cassette
264mm x 345mm

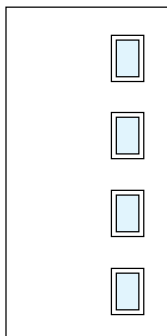

The Wirksworth
4 x twin top cassette
152mm x 202mm

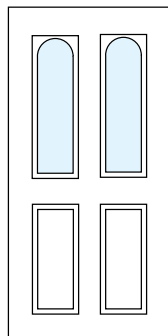

The Pilsley
Twin arch cassette
203mm x 912mm

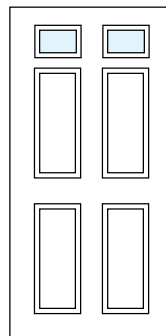

The Thorpe
Twin top cassettes
202mm x 1523mm

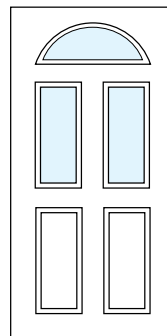

The Winstar
Half moon cassettes
R279mm x 250mm
Mid panel cassettes
202mm x 578mm

Fixing instructions



Step 1

1 - Pre-installation checks (see Step 1)

Before beginning any installation work, check the sizes, type, and condition of all door sets against both the survey sizes as well as actual aperture sizes. Also, check that you have all the ancillary components required before beginning to remove the existing door set.

2 - Positioning of door sets (see Step 2)

It is important that when installing a door outer frame, it is plumb and square within the aperture, without twist, racking or distortion of any member. Carefully position the new frame into the aperture making sure that it:

- Bridges the cavity
- Covers the DPC (damp proof course)
- Is set back as far as possible in the aperture to minimise exposure to the elements



Step 2

3 - Fixing in place (see Step 3)

Through-frame fixings should be plastic sheathed of minimum 100mm length and should penetrate a minimum 50mm into the substrate.

Generally, all four sides of the frame should be secured using our guidelines to determine fixing spacings and positions.

Use appropriately-sized installation packers adjacent to fixing positions to prevent the outer frame distorting during installation. Installation packers should be incompressible, resistant to rot or corrosion and span the width of the outer frame profile.

Apply a small amount of silicone mastic to the shanks and head of fixings that pass through the outer frame to ensure no water penetrates into the frame.



Step 3

4 - Finishing off and making good

Remove all protective films on the outer frame profiles as soon as the installation is finished and prior to perimeter sealing.

5 - Perimeter sealing (see Step 4)

The purpose of perimeter sealant is to prevent water and air leakage between the aperture and door set. Gaps can be sealed with a ribbon of silicone sealant, ensuring it fills the gap to a depth of no less than the width of the gap. Sand and cement or plaster **should not** be used to fill the gap between the frame and structural opening as it may crack with any movement in the joint. When sealing the perimeter joints, take care to ensure that any drainage channels are not blocked or obstructed.

6 - Hinge adjustment

Hinges on The Dales Collection are designed to offer three-way adjustment, which allows the door to be modified for compression, as well as vertically and laterally. All that is required are Allen keys. Any adjustments should be made gradually and equally on all hinges. If the compression of the door needs adjustment down the lock side of the door, this can be done by adjusting the keeps.

7 - Final inspection

After installation, an inspection should be carried out to ensure a correct fit. A checklist is provided with each Dales Collection door to ensure this can be done easily and efficiently.



Step 4

Conservatories



As the UK's largest profile extrusion brand, Eurocell offers a full package of conservatory components, from high-performance windows and doors to advanced roofing systems that are the crowning glory of any conservatory

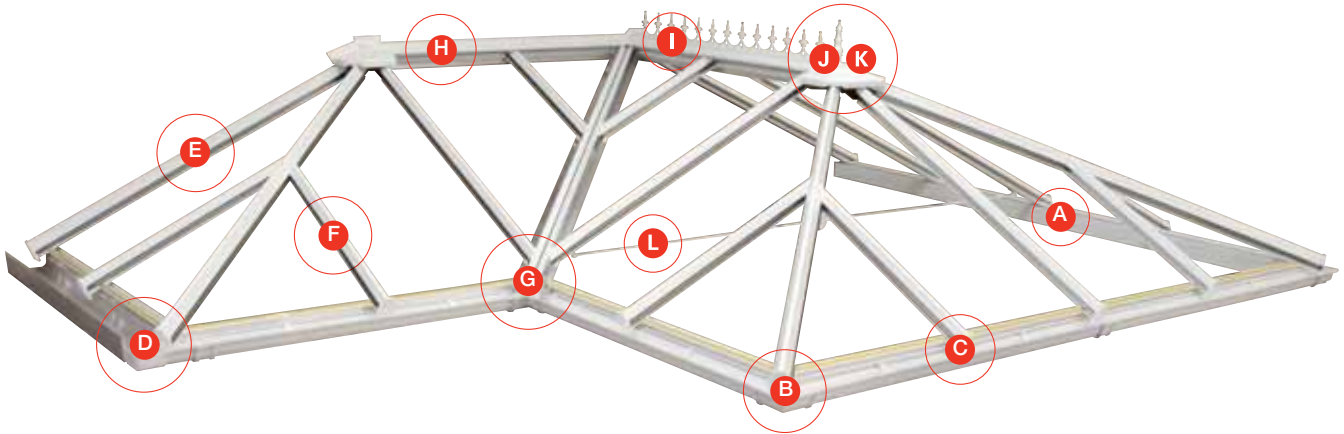

Whether you want the size and elegant looks of a traditional Victorian style conservatory or a compact lean-to outdoor room that won't take over the garden, we have a roof solution to meet your needs.

A Eaves beam

Incorporates a box section design for maximum strength and thermal efficiency. Available in either a fixed or variable pitch between 2.5° and 45°.

B Guttering

The gutter sits in front of eaves beam reducing any risk of overflow leakage and avoiding the need for having to fit special down pipe connectors.

C Rafter end assembly

Simple and neat clip up and over rafter bar end caps incorporate glazing stops for all roof designs.

D Box gutter

Silicone and tape-free box gutter adaptors for all weather installations. They are cut square to the external face of the frames below, rather than mitred over them minimising any risk of internal leakage.

E Gable-end rafters

Gable end bars for fixing to house walls are supplied with a patented built-in soaker system.

F Jack rafters

Adjustable fixing blocks link the hip bar to the jack rafter providing installation flexibility to ensure fast and neat water tight rafter connections.

G Valley assembly

Fully adjustable and linked valley wing system accommodates all pitch combinations while providing strong and effective watertight installations.

H Wall plate

Variable angle wall plate capable of pitches between 2.5° and 45°, and glazing in either 16mm, 25mm or 32mm polycarbonate and 24mm glass.

I Ridge top capping

Ridge top capping can be fixed into place before final glazing, providing easy access for sealing and lead work. Fully foiled ridge top capping for all woodgrain finishes to ensure consistent aesthetics.

J Ridge assembly and spider bars

Patented ridge end bung that simply bolts down around the spider assembly and onto the glazing panels, reducing any risk of water ingress and overcoming the need for silicone sealing.

K Finials and crestings

Moulded PVC-U or aluminium finials and crestings provide long-term visual appeal.

L Tie bars

When necessary, tie bars directly attach to the underside of the ridge - requiring no pre-preparation to the ridge under cladding.

Please note:

Conservatory roof systems are available to order from Eurocell branches.

Complete conservatory solutions supplied by Eurocell fabricators nationwide.

Traditional and contemporary conservatory roofs



Contemporary conservatory

Lusso faux-orangey roof

MOOD light and speaker system

Eurocell manufactures a wide range of bespoke conservatory roofs for a nationwide network of fabricators and installers. Available in a selection of beautiful styles, our cutting-edge roof system is guaranteed to enhance the character of any home. Fully compatible and colour-matched with all Eurocell window and door profile systems, our conservatory roofs are designed for simple fabrication and a secure, weather-tight finish.

The range of styles means that there's a roof to suit all conservatory shapes and sizes, including Victorian, Edwardian,

Gable-ended, P, T or L-shaped and lean-to conservatories. Plus, Eurocell can work with you to create bespoke contemporary design conservatories.

Our conservatory roofs incorporate many unique features. Gutter assemblies with fail safe designs ensure that minimum reliance is placed on silicone seals so that the risk of leaks is drastically reduced, while time-saving features ensure rapid, first-class installations. Such attention to detail means that your fitting team can spend more time making sure the job is perfect, instead of struggling against a system that's tricky

to install. We also offer a range of finishing touches to complete your conservatory, including a choice of crestings and finials, fans and electrically operated roof vents, plus our innovative Mood integrated conservatory speaker system.

Standard colour options and finishes:

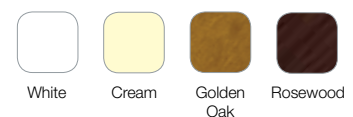

Other colours available on extended lead times, including Grey, Chartwell Green and Irish Oak

IQ750 modular conservatory roof



3m x 3m IQ750 modular conservatory roof in White

The IQ750 lean-to roof is the ultimate easy-to-install, off-the-shelf complete conservatory roof kit. Simply choose a size and pitch to suit the property you're working on – there's no on-site cutting or adjusting required, saving you time and money. The result is a bright, secure, energy-efficient roof that will enhance any conservatory.

The IQ750 roof is designed to create bright interiors with a reduced number of roof bars, while providing excellent energy efficiency with its opal polycarbonate roof panels.

The IQ750 kit is supplied with everything you need for a rapid installation, from trims and cappings to fixing studs and gutter brackets – and even the drill bits you will need for the job. The roof is available in a range of sizes and pitches, with the lowest pitch ideal for bungalows or areas where height restrictions apply. The IQ750 roof comes with a ten-year guarantee and is available to collect from your local Eurocell branch or with free delivery nationwide*.

Everlite Enduro



Everlite Enduro roof installation

Everlite Enduro is the leading lightweight translucent PVC-U roofing system – an ideal solution for conservatories, porches and carports. Quick and easy to install, Enduro requires minimal structural support and offers wide unobstructed free spans of up to 4m, making it your perfect roofing solution. For your complete peace of mind, Everlite Enduro comes with a 5-year manufacturer's guarantee.

Everlite Enduro roofs provide soft, naturally diffused light, preventing excessive glare. The panels transmit 63% visible light and virtually no UV light, which means they offer excellent sun protection. It's a thermally efficient roofing system too, with a U-value of 1.85W/mK.

Material:	PVC-U	Drip nose:	50mm
Design:	3 layer, 2 chamber	Thermal value:	1.85 (Wm ² K)
UV protection:	Co-extruded invisible UV layer	Freespan:	4 metre
Dimensions:	265.5mm (w) x 60mm (h)	Pitch:	Fixed at 2.5° (using width pack)
Length:	2m, 2.5m, 3m, 3.5m, 4m, 5m & 6m		5°+ (without width pack)

Silicone sealants



Silicone sealants are essential for any PVC-U installation. Choosing a high-quality sealant is vital to ensure the performance and integrity of any new roofline installation

Eurocell has developed the Silversil range of products to meet the needs of every installer. Silversil sealants, plus our advanced adhesives, foams and fillers, are designed for easy application, rapid curing and high performance. Take a look at the range of sealants summarised on these pages – all available from your local Eurocell branch.

LMN – Low Modulus Neutral

Silversil LMN is a high-quality neutral cure alcoxy silicone sealant.

- Easy to apply – single component silicone
- Low modulus, permanently flexible
- Colourfast – UV resistant
- Neutral alcoxy cure – releases alcohol while curing
- Excellent adhesion to common building materials
- Recommended for polycarbonate
- Mould resistant
- Conforms to BS5889A, ISO11600 F & G

Available in the following colour options:



TIP Eurocell recommends neutral cure silicone sealants for all PVC-U and polycarbonate applications, for safe, high-performance adhesion to masonry and PVC-U

LMA – Low Modulus Acetoxy

Silversil LMA is a high-quality acetoxy cure silicone sealant.

- Easy to apply – single component silicone
- Low modulus, permanently flexible
- Colourfast – UV resistant
- Excellent adhesion to common building materials
- Mould resistant
- Conforms to BS5889A, ISO11600 F & G

Available in the following colour options:



Lead

Silversil Lead is a high-quality neutral cure alcoxy silicone sealant for lead.

- Easy to apply – single component lead-grey silicone
- Low modulus, permanently flexible
- Colourfast – UV resistant
- Neutral alcoxy cure – releases alcohol while curing
- Excellent adhesion to lead and common building materials
- Recommended for polycarbonate
- Mould resistant
- Conforms to BS5889A, ISO11600 F & G

Available in the following colour options:



All-weather sealant & adhesive

Silversil all-weather sealant and adhesive is a high-modulus, high-performance, weather-resistant sealant and adhesive for construction applications.

- Easy to apply – single component sealant/adhesive
- Excellent adhesion to most substrates
- Fast cure
- Weather and water-resistant – ideal for roofline and skylight applications
- Abrasion-resistant – can be used in floor joints
- Permanently flexible – for sealing expansion joints
- Mould resistant
- Paintable
- Tested to ISO11600F 25HM, ASTM C1248-93, BS6920

Available in the following colour options:



Technical information



Colour fastness

Foam profiles / rigid profiles

BS1006 / 1990 Part A03 - Tests undertaken by BSI Testing for colour change resulted in an actual classification of 4 / 5 (where 1 = most change and 5 = least change).

Fire rating

Foam profiles

Tested to BS476 Part 7:1997 Class 1 surface spread of fire. Woodgrain profiles do not carry a fire rating.

Rigid profiles

Tested to BS476 Part7:1997 Class 1 surface spread of fire.

Thermal conductivity

Foam profiles 0.07 (w/mk)

This low coefficient of thermal conductivity for Foam Profiles indicates thermal insulation properties better than brick, concrete or timber.

Rigid profiles 0.14 (w/mk)

Density

Foam profiles 0.55 - 0.6 g/cm³

Rigid profiles 1.40 - 1.50 g/cm³

Maintenance

Foam and rigid profiles should not require any further maintenance other than the occasional wash down with a non-scratch, mild detergent and water. They are resistant to most acids and alkalis but can be damaged by solvents. Great care should be taken when in contact with creosote or bitumen-based products as these will cause staining of the profiles. Painting is not recommended on foam profiles unless done by an approved contractor.

Workability

Foam profiles

Eurocell cellular foam PVC-U products are easy to work with using normal hand tools for drilling and cutting. It is recommended that the saw should have a fine tooth blade (PVC-U saws are available from Eurocell branches). PVC-U products should not be fitted below 0°C as the boards may become brittle.

Handling and storage

Profiles are packed in polythene sleeves identifying a particular shade of white. Protective tape should only be removed immediately before installation to prevent damage.

British Standards

The Eurocell Building Plastics products supplied by Eurocell Profiles Ltd are produced in accordance with a BS EN ISO 9001:2000 accredited quality system.

Guarantees

Based on the technical testing information obtained from BSI, the white foam and rigid profiles are covered by a 20-year guarantee and foiled woodgrain foam and rigid profiles are covered by a 10-year guarantee on colour fastness, provided they are fitted to the manufacturers recommendations.

Accreditations

Eurocell products have been rigorously tested and independently assessed to ensure they meet all current legislation and the highest quality standards. Our products are accredited to the following standards:



Assessment report number 01/3784.
The Eurocell cladding system



Eurocell's composite doors have gained Secured by Design status



Assessment report number 01/3783.
The Eurocell roofline system



Eurocell is a member of the British Plastics Foundation



Assessment report number 04/4156.
The Eurocell conservatory roof system



ISO 14001 Accreditation
Eurocell's environmental management activities are ISO 14001 accredited



BS 7619
(certificate number KM 556478)

Extruded Cellular Unplasticized (PVC-UE) Profiles



BS EN ISO 9001:2008
(CERTIFICATE NUMBER FM 45551)

BSI registered firm

PAS 23/24

ERA test centre - to PAS 23-1 and PAS 24-1
Certificate number 050
The Eurocell composite door system



Member of PVC-U Aware



Q-mark
BM Trada Q Mark accredited, for enhanced door security.
The Eurocell composite door system



Partner

Awards



Manufacturer of the year



Materials Recycler of the Year (large)

What our customers say



Take a look at our case studies to find out how Eurocell products and the exceptional service offered by our branches are fulfilling the needs of customers across the country



Client: Gladedale Homes
Project: National supply contract

Eurocell secured a major contract with leading house builder Gladedale to supply a full range of roofline and window trim products. Gladedale now sources all of its building plastics from Eurocell, including roofline, windows and doors, ensuring that its homeowners enjoy the benefits of perfect PVC-U colour matching throughout their properties.

Eurocell was able to offer a comprehensive range of benefits to Gladedale because it manufactures most of the products that are distributed through its branches. Having this control over the supply chain,

from manufacture through to site delivery, enables Eurocell to provide consistently high quality products and real value for money.

Martin Sanwell, Procurement Director at Gladedale, says: "We liked the quality, range and value of Eurocell's products and it is a definite advantage that sourcing everything from a single supplier means perfect colour matching on all our properties. Backing this up with a 125+ branch network created an unbeatable combination and will mean efficient sourcing for our sites across the country."



Client: Miller Homes
Project: National supply contract

Miller Homes has become the latest housebuilder to take advantage of Eurocell's complete building plastics solution, entering an agreement to source its full range of roofline products from Eurocell branches. This will be complemented by windows supplied by Eurocell fabricators around the UK.

Miller Homes had previously sourced through a variety of different suppliers, resulting in duplication of administration and distribution resources. This meant that stock from different suppliers had to be kept separate to ensure consistent colour matching on-site.

Being able to source everything from Eurocell – a single supplier – ensures a perfect colour match throughout the property. As potential house buyers become more discerning, this will provide another valuable selling point for Miller Homes.

"It was a carefully considered decision to choose Eurocell and the benefits are huge," said Darren O'Reilly, Head of Procurement at Miller Homes, "there are very few companies that have such a comprehensive offer as Eurocell, which will allow us to make significant efficiency savings."



Client: Wates Living Space
Project: Lakeside Extra Care development

Wates Living Space has specified Eurocell products on a flagship Extra Care scheme in Cannock for South Staffordshire Housing Associations.

Grey fascia and soffits were chosen because it created the visual appearance of aluminium, which had originally been specified on the development, as well as offering the same performance and low maintenance benefits.

Hannah Hobbs, Buyer at Wates Living Space - West Region, said: "Grey roofline from Eurocell gave us the visual appearance and long term, low maintenance

benefits of aluminium, all backed up by comprehensive guarantees. Once South Staffordshire Housing Association had seen the Eurocell samples and realised the significant cost savings it made, it was an easy decision to change the fascia and soffit specification from aluminium to PVC-U."

Wates Living Space designed and built the new £8m facility in Cannock, which incorporates 83 apartments. The Lakeside Extra Care development enables people aged 55 and over to live independently in their own home with features such as added security and staff on site when needed by residents.

Full product range at a glance

Fascia, capping and soffit boards

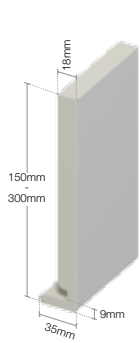

EB 150, 175, 200, 225, 250 and 300

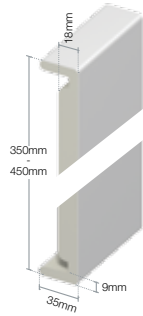

DEB 350 and 450

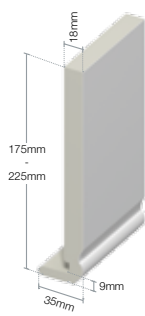

OGE 175, 200 and 225



DOGE 400

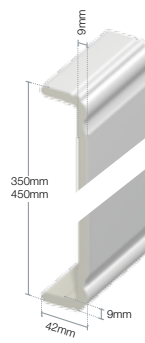

DOCB 350 and DOCB 450

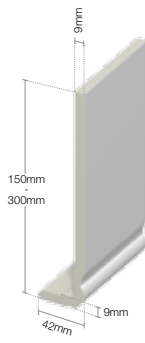

OCB 150, 175, 200, 225, 250, 300 and 350

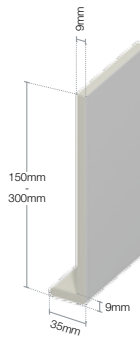

CB 150, 175, 200, 225, 250 and 300

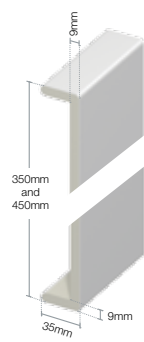

DCB 350 and 450

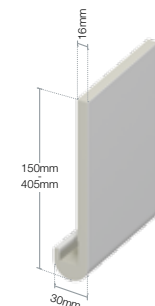

BN 150, 175, 200, 225, 250, and 355

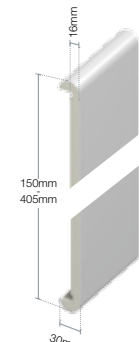

BN 405

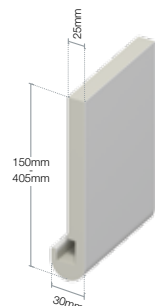

EBN 150, 175, 200, 225, 250

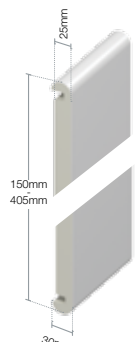

EBN 405

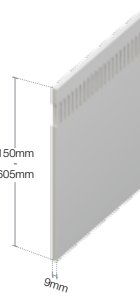

ES 150, 200, 225, 250, 300, 350, 400 and 605

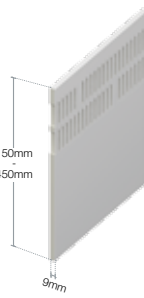

DES 150, 225, 300 and 450

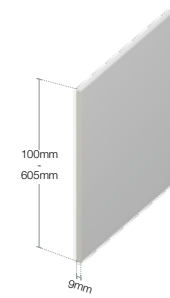

UB 100, 125, 150, 175, 200, 225, 250, 300, 350, 400, 450 and 605

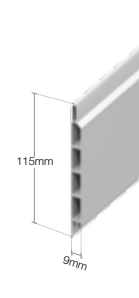

SB 100 and 300

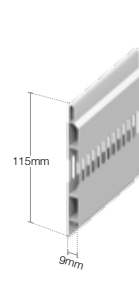

VB 100 and 300

Roofline trims



DOGJT



DOGCT

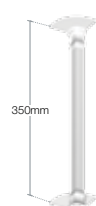

DOGICT90



DOGJTA 135

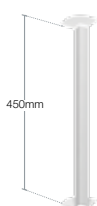

DCBICT 90

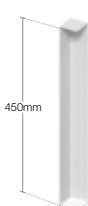

DCBCT



DCBJT

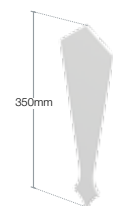

RF 1

Eaves protection, ventilators and fixings

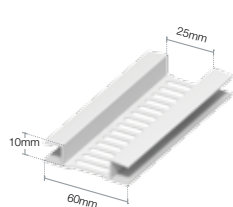

SV 10

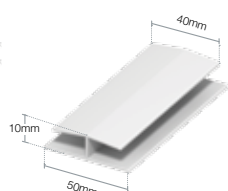

PJ 40

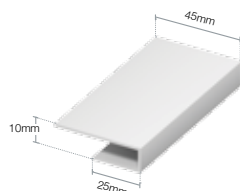

BC 25

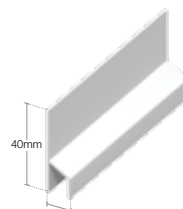

FET 40

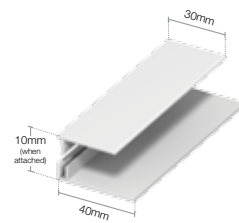

PT 30

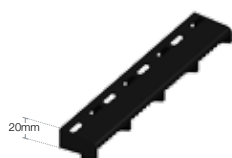

OFV 1

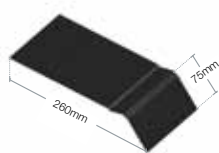

GEP

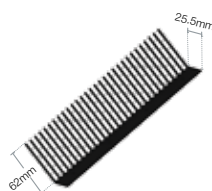

BCF 55

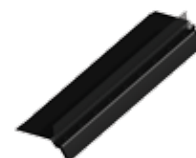

OFVS 10



CSV 70



FP 30 / 40



FN 50 / 65



CS 50

Cladding

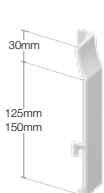

BJ 100, 125 and 150

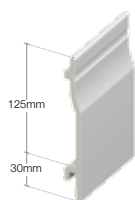

SC 125

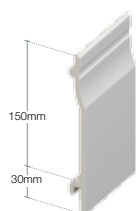

SC 150

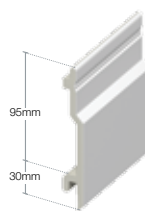

OV 100

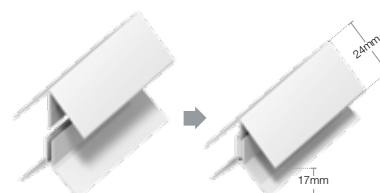

AT 125

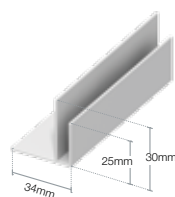

ST 125

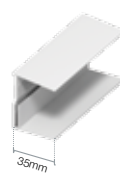

ET 125

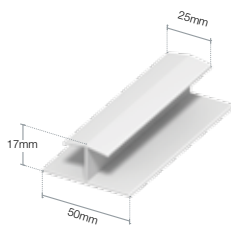

JT 125

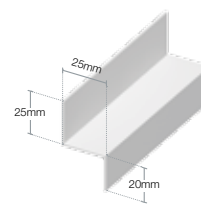

DT 125



CP 25 / 30

Cills

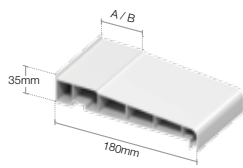

AC180 (A = 57mm)
BC180 (B = 53mm)

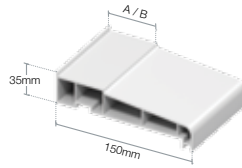

AC150 (A = 57mm)
BC150 (B = 53mm)

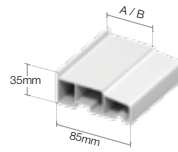

AS85 (A = 57mm)
BS85 (B = 53mm)



EWS 118

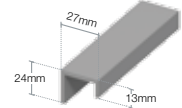

CR 27P



JTA 135 - 150



JTA 90E



JTA 90i



JT 150



ECA 150 - 180
ECB 150 - 180



A EC 85
B EC 85

Window finishing trims



BCB 250



WB 150, 175, 200,
225, 250, 300 and 405

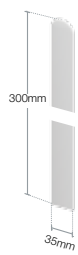

DEC

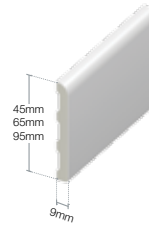

PR 45, 65
and 95

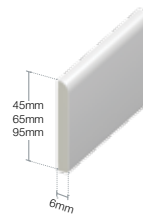

PF 45, 65
and 95

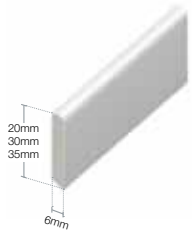

C 20, 30
and 35



OGEE50

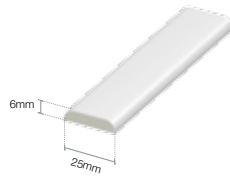

D 25

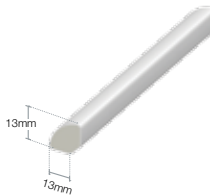

Q13 and 175

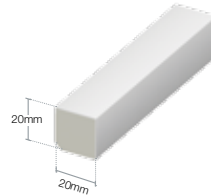

S 20



B 20



WTEC



WBECL



WBECS



CBEC

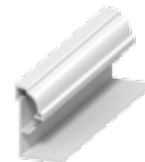

EWS 129



EWS 229



GRA 4040



AA50 and AA75

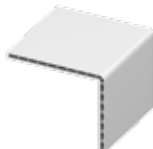

HA1008

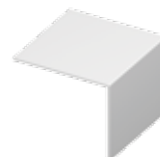

RA 1008

Also available in:
RA 8080 (80mm x 80mm)
RA 6060 (60mm x 60mm)
RA 6535 (65mm x 35mm)
RA 2525 (25mm x 25mm)

Complete range colour guide



All together better

Fascia board - standard and ogee

Capping board - standard and ogee

Code	Description	White	Cream	Golden Oak	Rosewood	Irish Oak	White Ash	Grey	Warm White	Blue White	Black Ash	Dark Brown	Oak	Terracotta	Clay Brown
EB 150	150mm Euroboard	✓	✓	✓	✓	✓	✓	✓	×	×	✓	×	×	×	×
EB 175	175mm Euroboard	✓	✓	✓	✓	✓	✓	✓	×	×	✓	×	×	×	×
EB 200	200mm Euroboard	✓	✓	✓	✓	✓	✓	✓	×	×	✓	×	×	×	×
EB 225	225mm Euroboard	✓	✓	✓	✓	✓	✓	✓	×	×	✓	×	×	×	×
EB 250	250mm Euroboard	✓	×	✓	✓	×	×	×	×	×	×	×	×	×	×
EB 300	300mm Euroboard	✓	×	×	×	×	×	×	×	×	×	×	×	×	×
DEB 350	350mm double Euroboard	✓	×	✓	✓	×	×	×	×	×	✓	×	×	×	×
DEB 450	450mm double Euroboard	✓	✓	✓	✓	✓	✓	✓	×	×	✓	×	×	×	×
BEEB 450	450mm Euroboard box end	✓	×	✓	✓	×	×	×	×	×	✓	×	×	×	×
OGE 175	175mm Ogee Euroboard	✓	×	×	×	×	×	×	×	×	×	×	×	×	×
OGE 200	200mm Ogee Euroboard	✓	×	×	×	×	×	×	×	×	×	×	×	×	×
OGE 225	225mm Ogee Euroboard	✓	×	×	×	×	×	×	×	×	×	×	×	×	×
DOGE 400	175mm double Ogee Euroboard	✓	×	×	×	×	×	×	×	×	×	×	×	×	×
BEUGE 400	400mm Ogee Euroboard box end	✓	×	×	×	×	×	×	×	×	×	×	×	×	×
BN 150	16mm x 150mm bull-nosed fascia	✓	×	×	×	×	×	×	×	×	×	×	×	×	×
BN 175	16mm x 175mm bull-nosed fascia	✓	×	×	×	×	×	×	×	×	×	×	×	×	×
BN 200	16mm x 200mm bull-nosed fascia	✓	×	×	×	×	×	×	×	×	×	×	×	×	×
BN 225	16mm x 225mm bull-nosed fascia	✓	×	×	×	×	×	×	×	×	×	×	×	×	×
BN 250	16mm x 250mm bull-nosed fascia	✓	×	×	×	×	×	×	×	×	×	×	×	×	×
BN 355	16mm x 355mm bull-nosed fascia	✓	×	×	×	×	×	×	×	×	×	×	×	×	×
BN 405	16mm x 405mm bull-nosed fascia	✓	×	×	×	×	×	×	×	×	×	×	×	×	×
EBN 150	25mm x 150mm bull-nosed fascia	✓	×	×	×	×	×	×	×	×	×	×	×	×	×
EBN 175	25mm x 175mm bull-nosed fascia	✓	×	×	×	×	×	×	×	×	×	×	×	×	×
EBN 200	25mm x 200mm bull-nosed fascia	✓	×	×	×	×	×	×	×	×	×	×	×	×	×
EBN 225	25mm x 225mm bull-nosed fascia	✓	×	×	×	×	×	×	×	×	×	×	×	×	×
EBN 250	25mm x 250mm bull-nosed fascia	✓	×	×	×	×	×	×	×	×	×	×	×	×	×
DEBN 405	25mm x 405mm double bull-nosed fascia	✓	×	×	×	×	×	×	×	×	×	×	×	×	×
CB 150	150mm capping board	✓	×	✓	✓	×	×	×	✓	✓	✓	×	×	×	×
CB 175	175mm capping board	✓	✓	✓	✓	✓	✓	✓	✓	✓	✓	×	×	×	×
CB 200	200mm capping board	✓	×	✓	✓	×	×	×	✓	✓	✓	×	×	×	×
CB 225	225mm capping board	✓	✓	✓	✓	✓	✓	✓	✓	✓	✓	×	×	×	×
CB 250	250mm capping board	✓	×	✓	✓	×	×	×	×	×	×	×	×	×	×
CB 300	300mm capping board	✓	×	×	×	×	×	×	×	×	×	×	×	×	×
DCB 350	350mm double capping board	✓	×	✓	✓	×	×	×	×	×	✓	×	×	×	×
DCB 450	450mm double capping board	✓	×	✓	✓	×	×	×	×	✓	✓	×	×	×	×
BECEB450	450mm capping board box end	✓	×	✓	✓	×	×	×	×	×	×	×	×	×	×
OCB 150	150mm Ogee capping board	✓	×	✓	✓	×	×	×	×	×	×	×	×	×	×
OCB 175	175mm Ogee capping board	✓	×	✓	✓	×	×	×	×	×	×	×	×	×	×
OCB 200	200mm Ogee capping board	✓	×	✓	✓	×	×	×	×	×	×	×	×	×	×
OCB 225	225mm Ogee capping board	✓	×	✓	✓	×	×	×	×	×	×	×	×	×	×
OCB 250	250mm Ogee capping board	✓	×	×	×	×	×	×	×	×	×	×	×	×	×
OCB 300	300mm Ogee capping board	✓	×	×	×	×	×	×	×	×	×	×	×	×	×
DOCB 350	350mm double Ogee capping board	✓	×	✓	✓	×	×	×	×	×	×	×	×	×	×
DOCB 450	450mm double Ogee capping board	✓	×	✓	✓	×	×	×	×	×	×	×	×	×	×
CBEC	Capping board end caps	✓	×	×	×	×	×	×	×	✓	×	×	✓	×	×

	Code	Description	White	Cream	Golden Oak	Rosewood	Irish Oak	White Ash	Grey	Warm White	Blue White	Black Ash	Oak	Terracotta	Clay Brown	Brown	Black
Utility board	UB 100	100mm utility board	✓	×	✓	✓	×	×	×	✓	×	×	×	×	×	×	×
	UB 125	125mm utility board	✓	×	×	×	×	×	×	×	×	×	×	×	×	×	×
	UB 150	150mm utility board	✓	✓	✓	✓	×	×	×	✓	✓	✓	×	×	×	×	×
	UB 175	175mm utility board	✓	×	×	×	×	×	×	×	✓	×	×	×	×	×	×
	UB 200	200mm utility board	✓	✓	✓	✓	×	×	×	✓	✓	✓	×	×	×	×	×
	UB 225	225mm utility board	✓	×	✓	×	×	×	×	×	✓	×	×	×	×	×	×
	UB 250	250mm utility board	✓	×	×	×	×	×	×	×	×	×	×	×	×	×	×
	UB 300	300mm utility board	✓	✓	✓	✓	✓	✓	✓	✓	×	✓	×	×	×	×	×
	UB 350	350mm utility board	✓	×	×	×	×	×	×	×	×	×	×	×	×	×	×
	UB 400	400mm utility board	✓	×	✓	✓	×	×	×	×	×	×	×	×	×	×	×
	UB 450	450mm utility board	✓	×	×	×	×	×	×	×	×	×	×	×	×	×	×
	UB 605	605mm utility board	✓	×	×	×	×	×	×	×	×	×	×	×	×	×	×
Soffit board - 10mm and 25mm airspace	ES 150	150mm Eurosoffit board (10mm airspace)	✓	×	✓	✓	×	×	×	×	×	✓	×	×	×	×	×
	ES 200	200mm Eurosoffit board (10mm airspace)	✓	×	✓	✓	×	×	×	×	×	✓	×	×	×	×	×
	ES 225	225mm Eurosoffit board (10mm airspace)	✓	×	×	×	×	×	×	×	×	×	×	×	×	×	×
	ES 250	250mm Eurosoffit board (10mm airspace)	✓	×	×	×	×	×	×	×	×	×	×	×	×	×	×
	ES 300	300mm Eurosoffit board (10mm airspace)	✓	×	✓	✓	×	×	×	×	×	✓	×	×	×	×	×
	ES 400	400mm Eurosoffit board (10mm airspace)	✓	×	×	×	×	×	×	×	×	×	×	×	×	×	×
	ES 605	605mm Eurosoffit board (10mm airspace)	✓	×	×	×	×	×	×	×	×	×	×	×	×	×	×
	DES 150	150mm Eurosoffit board (25mm airspace)	✓	×	×	×	×	×	×	×	×	×	×	×	×	×	×
	DES 225	225mm Eurosoffit board (25mm airspace)	✓	×	×	×	×	×	×	×	×	×	×	×	×	×	×
	DES 300	300mm Eurosoffit board (25mm airspace)	✓	×	×	×	×	×	×	×	×	×	×	×	×	×	×
	DES 450	450mm Eurosoffit board (25mm airspace)	✓	×	×	×	×	×	×	×	×	×	×	×	×	×	×
	Hollow soffit board	VB 100	100mm vented hollow soffit board	✓	×	×	×	×	×	×	×	×	×	×	×	×	×
VB 300		300mm vented hollow soffit board	✓	×	×	×	×	×	×	×	×	×	×	×	×	×	×
SB 100		100mm hollow soffit board	✓	×	✓	✓	×	×	×	×	×	×	×	×	×	×	×
SB 300		300mm hollow soffit board	✓	✓	✓	✓	✓	✓	✓	×	×	✓	×	×	×	×	×
Finishing trims and fixings	DCBJT	Double capping board joint trim	✓	✓	✓	✓	✓	✓	✓	✓	×	✓	✓	×	×	×	×
	DCBCT	Double capping board corner trim	✓	✓	✓	✓	✓	✓	✓	✓	×	✓	✓	×	×	×	×
	DCBICT 90	Double 90° internal corner trim	✓	✓	✓	×	✓	✓	✓	×	×	×	×	×	×	×	×
	CBECT 135	Universal external 135° corner trim	✓	✓	✓	✓	✓	×	×	×	×	✓	×	×	×	×	×
	DOGJT	Double Ogee joint trim	✓	×	✓	✓	×	×	×	×	×	×	✓	×	×	×	×
	DOGCT	Double Ogee corner trim	✓	×	✓	✓	×	×	×	×	×	×	✓	×	×	×	×
	DOGICT 90	Double Ogee 90° internal corner trim	✓	×	✓	✓	×	×	×	×	×	×	×	×	×	×	×
	DOGJTA 135	Double Ogee 135° external angle trim	✓	×	✓	×	×	×	×	×	×	×	✓	×	×	×	×
	BNJT	Double bull-nosed joint trim	✓	×	×	×	×	×	×	×	×	×	×	×	×	×	×
	BNCT	Double bull-nosed corner trim	✓	×	×	×	×	×	×	×	×	×	×	×	×	×	×
	BNICT	Double bull-nosed internal corner trim	✓	×	×	×	×	×	×	×	×	×	×	×	×	×	×
	FP 30	30mm fixing pins	✓	✓	✓	✓	×	×	✓	×	×	×	✓	×	×	✓	✓
	FP 40	40mm fixing pins	✓	✓	×	✓	×	×	✓	×	×	×	✓	×	×	✓	✓
	FN 50	50mm fixing nails	✓	✓	×	✓	×	×	✓	×	×	×	✓	×	×	✓	✓
	FN 65	65mm fixing nails	✓	×	×	✓	×	×	✓	×	×	×	✓	×	×	✓	✓
	CS 50	50mm capping screws	✓	×	×	×	×	×	×	×	×	×	×	×	×	×	×
RF 1	Roofline finial	✓	✓	✓	✓	✓	✓	✓	×	×	✓	✓	×	×	×	×	
Ventilators and accessories	PT 30	30mm panel trim	✓	×	×	×	×	×	×	×	×	✓	×	×	×	×	
	PJ 40	40mm panel joint	✓	✓	✓	✓	✓	✓	×	×	✓	✓	×	×	×	×	
	BC 25	25mm board clip	✓	✓	✓	✓	✓	✓	×	×	✓	✓	×	×	×	×	
	SV 10	10mm soffit ventilator	✓	×	×	×	×	×	×	×	×	✓	×	×	×	×	
	CSV 70	70mm disc ventilator	✓	×	×	×	×	×	×	×	×	✓	×	×	×	×	
	FET 40	40mm felt edge trim	✓	×	×	×	×	×	×	×	×	×	×	×	×	×	
	OFV 1	10mm over fascia ventilator	×	×	×	×	×	×	×	×	×	×	×	×	×	×	✓
	GEP	Felt tray	×	×	×	×	×	×	×	×	×	×	×	×	×	×	✓
	OFVS 10	10mm over fascia ventilator with comb	×	×	×	×	×	×	×	×	×	×	×	×	×	×	✓
	BCF 55	Eaves comb filler	×	×	×	×	×	×	×	×	×	×	×	×	×	×	✓

	Code	Description	White	Cream	Golden Oak	Rosewood	Irish Oak	White Ash	Grey	Warm White	Blue White	Black Ash	Oak	Terracotta	Clay Brown	Brown	Black	
Dry verge	9765	Dry verge unit (left hand)	✓	×	×	×	×	×	✓	×	×	×	×	✓	×	✓	✓	
	9770	Dry verge unit (right hand)	✓	×	×	×	×	×	✓	×	×	×	×	✓	×	✓	✓	
	9772	Half-round ridge end pack	✓	×	×	×	×	×	✓	×	×	×	×	✓	×	✓	✓	
	9733	Eaves ridge pack	✓	×	×	×	×	×	✓	×	×	×	×	✓	×	✓	✓	
	9773	Universal angle ridge end pack	✓	×	×	×	×	×	✓	×	×	×	×	✓	×	✓	✓	
	9771	Batten end clip	✓	×	×	×	×	×	×	×	×	×	×	×	×	×	×	×
	9803	Continuous dry verge T-strip	✓	×	×	×	×	×	×	×	×	×	×	×	×	×	×	×
Cladding and trims	SC 125	125mm shiplap cladding	✓	×	✓	✓	×	×	×	×	×	✓	×	×	×	×	×	
	SC 150	150mm shiplap cladding	✓	×	✓	✓	×	×	×	×	×	×	×	×	×	×	×	
	OV 100	100mm open V cladding	✓	×	✓	✓	×	×	×	×	×	×	×	×	×	×	×	
	ST 125	125mm starter trim	✓	×	×	×	×	×	×	×	×	×	✓	×	×	×	×	
	ET 125	125mm edge trim	✓	×	✓	✓	×	×	×	×	×	✓	✓	×	×	×	×	
	AT 125	125mm angle trim	✓	×	✓	✓	×	×	×	×	×	✓	✓	×	×	×	×	
	DT 125	125mm drip trim	✓	×	✓	✓	×	×	×	×	×	✓	✓	×	×	×	×	
	JT 125	125mm joint trim	✓	×	✓	✓	×	×	×	×	×	✓	✓	×	×	×	×	
	BJ 100	100mm butt joint	✓	×	✓	✓	×	×	×	×	×	×	✓	×	×	×	×	
	BJ 125	125mm butt joint	✓	×	✓	✓	×	×	×	×	×	✓	✓	×	×	×	×	
	BJ 150	150mm butt joint	✓	×	✓	✓	×	×	×	×	×	✓	✓	×	×	×	×	
	CP 25	25mm cladding pins	×	×	×	×	×	×	×	×	×	×	×	×	×	×	×	
	CP 30	30mm cladding pins	×	×	×	×	×	×	×	×	×	×	×	×	×	×	×	
Window cills	AS 85	85mm A type cill	✓	✓	✓	✓	✓	✓	×	×	×	✓	✓	×	×	×	×	
	AC 150	150mm A type cill	✓	✓	✓	✓	✓	✓	✓	×	×	✓	✓	×	×	×	×	
	AC 180	180mm A type cill	✓	✓	✓	✓	✓	×	×	✓	×	✓	✓	×	×	×	×	
	PC 225	225mm A type cill	✓	×	×	×	×	×	×	×	×	×	×	×	×	×	×	
	ECA 85	85mm A type cill end cap	✓	✓	×	×	×	×	×	✓	×	×	✓	×	×	×	×	
	ECA 150	150mm A type cill end cap	✓	✓	×	×	×	×	✓	×	×	✓	✓	×	×	×	×	
	ECA 180	180mm A type cill end cap	✓	✓	×	×	×	×	✓	✓	×	✓	✓	×	×	×	×	
	PEC 225	225mm A type cill end cap	✓	×	×	×	×	×	×	×	×	×	×	×	×	×	×	
	JT 150	150mm straight cill joint trim	✓	×	×	×	×	×	×	×	×	×	✓	×	×	×	×	
	JTA 90E	90° external angle cill joint trim	✓	×	×	×	×	×	×	×	×	×	✓	×	×	×	×	
	JTA 90I	90° internal angle cill joint trim	✓	×	×	×	×	×	×	×	×	×	✓	×	×	×	×	
	JTA 135	135° angle cill joint trim	✓	×	×	×	×	×	×	×	×	×	✓	×	×	×	×	
	JTA 150	150° angle cill joint trim	✓	×	×	×	×	×	×	×	×	×	✓	×	×	×	×	
	CR 27P	27mm cill reinforcement	×	×	×	×	×	×	✓	×	×	×	×	×	×	×	×	✓
	Window boards	WB 150	150mm window board	✓	×	×	×	×	×	×	×	×	×	×	×	×	×	×
WB 175		175mm window board	✓	×	✓	✓	×	×	×	×	×	×	×	×	×	×	×	
WB 200		200mm window board	✓	×	✓	✓	×	×	×	×	×	×	×	×	×	×	×	
WB 225		225mm window board	✓	×	✓	✓	×	×	×	×	×	×	×	×	×	×	×	
WB 250		250mm window board	✓	×	×	×	×	×	×	×	×	×	×	×	×	×	×	
WB 300		300mm window board	✓	×	×	×	×	×	×	×	×	×	×	×	×	×	×	
WB 405		405mm window board	✓	×	×	×	×	×	×	×	×	×	×	×	×	×	×	
EWS 129		Window board retainer trim	✓	×	✓	✓	×	×	×	×	×	×	×	×	×	×	×	
EWS 229		Window board retainer trim end cap	✓	✓	✓	✓	×	×	×	×	×	×	×	×	×	×	×	
DEC		Double end caps	✓	×	×	×	×	×	×	✓	×	×	✓	×	×	×	×	
WBECS		Window board end caps	✓	×	×	×	×	×	×	×	×	×	✓	×	×	×	×	
Window finishing trims	PR 45	45mm pencil round architrave (castellated)	✓	×	✓	×	×	×	×	×	×	×	×	×	×	×	×	
	PR 65	65mm pencil round architrave (castellated)	✓	×	×	×	×	×	×	×	×	×	×	×	×	×	×	
	PR 95	95mm pencil round architrave (castellated)	✓	×	×	×	×	×	×	×	×	×	×	×	×	×	×	
	PF 45	45mm pencil round architrave (flat back)	✓	×	✓	✓	×	✓	✓	✓	✓	✓	×	×	×	×	×	
	PF 65	65mm pencil round architrave (flat back)	✓	✓	✓	✓	×	✓	✓	✓	✓	✓	×	×	×	×	×	
	PF 95	95mm pencil round architrave (flat back)	✓	✓	✓	✓	×	✓	✓	✓	✓	✓	×	×	×	×	×	
	Q 13	13mm quadrant	✓	✓	✓	✓	✓	✓	✓	✓	✓	×	×	×	×	×	×	
	Q 175	17.5mm quadrant	✓	✓	✓	✓	✓	✓	✓	✓	✓	×	×	×	×	×	×	

Window finishing trims continued

Code	Description	White	Cream	Golden Oak	Rosewood	Irish Oak	White Ash	Grey	Warm White	Blue White	Black Ash	Oak	Terracotta	Clay Brown	Brown	Black
D 25	25mm d moulding	✓	✓	✓	✓	✓	✓	✓	✓	✓	✓	×	×	×	×	×
C 20	20mm cloaking fillet	✓	✓	✓	✓	✓	✓	×	✓	✓	×	×	×	×	×	×
C 30	30mm cloaking fillet	✓	✓	✓	✓	✓	✓	✓	✓	✓	×	×	×	×	×	×
C 35	35mm cloaking fillet	✓	×	✓	✓	×	×	×	×	×	×	×	×	×	×	×
S 20	20mm square	✓	×	✓	✓	×	×	×	✓	×	✓	×	×	×	×	×
B 20	20mm x 15mm bead	✓	×	✓	✓	×	×	×	×	✓	×	×	×	×	×	×
GAA 50	50mm adjustable angle	✓	×	✓	✓	×	×	×	×	×	×	×	×	×	×	×
GAA 70	70mm adjustable angle	✓	×	✓	✓	×	×	×	×	×	×	×	×	×	×	×
GAA 100	100mm adjustable angle	✓	×	✓	✓	×	×	×	×	×	×	×	×	×	×	×
RA 2525	25mm x 25mm rigid angle	✓	×	✓	✓	×	×	×	×	×	×	×	×	×	×	×
RA 6535	65mm x 35mm rigid angle	✓	×	×	×	×	×	×	×	×	×	×	×	×	×	×
GRA 4040	40mm x 40mm rigid angle	✓	×	✓	✓	×	×	×	×	×	×	×	×	×	×	×
RA 6060	60mm x 60mm rigid angle	✓	×	✓	✓	×	×	×	×	×	×	×	×	×	×	×
RA 8080	80mm x 80mm rigid angle	✓	×	✓	✓	×	×	×	×	×	×	×	×	×	×	×
RA 1008	100mm x 80mm rigid angle	✓	×	✓	✓	×	×	×	×	×	×	×	×	×	×	×
HA 1008	100mm x 80mm hollow angle	✓	×	✓	✓	×	×	×	×	×	×	×	×	×	×	×

Square-line guttering 114mm x 59mm

RWSG 2	2m gutter	✓	×	×	×	×	×	×	×	×	×	×	×	×	✓	✓
RWSG 4	4m gutter	✓	×	×	×	×	×	×	×	×	×	×	×	✓	✓	✓
RWSA 1	90° angle	✓	×	×	×	×	×	×	×	×	×	×	×	✓	✓	✓
RWSA 2	135° angle	✓	×	×	×	×	×	×	×	×	×	×	×	✓	✓	✓
RWSE 1	Stop end external	✓	×	×	×	×	×	×	×	×	×	×	×	✓	✓	✓
RWSE 2	Stop end internal	✓	×	×	×	×	×	×	×	×	×	×	×	✓	✓	✓
RWSFB 1	Fascia bracket	✓	×	×	×	×	×	×	×	×	×	×	×	✓	✓	✓
RWSFB 2	Top hung fascia bracket	✓	×	×	×	×	×	×	×	×	×	×	×	✓	✓	✓
RWSO 1	Running outlet	✓	×	×	×	×	×	×	×	×	×	×	×	✓	✓	✓
RWSO 2	Stop end outlet	✓	×	×	×	×	×	×	×	×	×	×	×	✓	✓	✓
RWSU 1	Union bracket	✓	×	×	×	×	×	×	×	×	×	×	×	✓	✓	✓

Half-round guttering 114mm x 51mm

RWG 2	2m gutter	✓	×	×	×	×	×	✓	×	×	×	×	×	×	✓	✓
RWG 4	4m gutter	✓	×	×	×	×	×	✓	×	×	×	×	×	×	✓	✓
RWA 1	90° angle	✓	×	×	×	×	×	✓	×	×	×	×	×	×	✓	✓
RWA 2	135° angle	✓	×	×	×	×	×	✓	×	×	×	×	×	×	✓	✓
RWE 1	Stop end external	✓	×	×	×	×	×	✓	×	×	×	×	×	×	✓	✓
RWE 2	Stop end internal	✓	×	×	×	×	×	✓	×	×	×	×	×	×	✓	✓
RWFB 1	Fascia bracket	✓	×	×	×	×	×	✓	×	×	×	×	×	×	✓	✓
RWO 1	Running outlet	✓	×	×	×	×	×	✓	×	×	×	×	×	×	✓	✓
RWO 2	Stop end outlet	✓	×	×	×	×	×	✓	×	×	×	×	×	×	✓	✓
RWU 1	Union bracket	✓	×	×	×	×	×	✓	×	×	×	×	×	×	✓	✓

Universal Plus guttering 128mm x 88mm

RWKG 4	4m gutter	✓	×	×	×	×	×	×	×	×	×	×	×	✓	✓	✓
RWKA1	External angle 90°	✓	✓	×	×	×	×	×	×	×	×	×	×	✓	✓	✓
RWKA 2	External angle 135°	✓	✓	×	×	×	×	×	×	×	×	×	×	✓	✓	✓
RWKA 3	Internal angle 90°	✓	✓	×	×	×	×	×	×	×	×	×	×	✓	✓	✓
RWKA 4	External angle 150°	✓	×	×	×	×	×	×	×	×	×	×	×	✓	✓	✓
RWKA 5	Internal angle 135°	✓	×	×	×	×	×	×	×	×	×	×	×	✓	✓	✓
RWKFB 1	Fascia bracket	✓	✓	×	×	×	×	×	×	×	×	×	×	✓	✓	✓
RWKFB 2	Top hung fascia bracket	✓	✓	×	×	×	×	×	×	×	×	×	×	✓	✓	✓
RWKE 1	Stop-end external (right hand)	✓	✓	×	×	×	×	×	×	×	×	×	×	✓	✓	✓
RWKE 2	Stop-end external (left hand)	✓	✓	×	×	×	×	×	×	×	×	×	×	✓	✓	✓
RWKO 1	Running outlet	✓	✓	×	×	×	×	×	×	×	×	×	×	✓	✓	✓
RWKO 2	Stop end outlet (right hand)	✓	✓	×	×	×	×	×	×	×	×	×	×	✓	✓	✓
RWKO 3	Stop end outlet (left hand)	✓	✓	×	×	×	×	×	×	×	×	×	×	✓	✓	✓
RWKU 1	Union bracket	✓	✓	×	×	×	×	×	×	×	×	×	×	✓	✓	✓
RWKD 6	Universal Plus square adaptor (left hand)	✓	×	×	×	×	×	×	×	×	×	×	×	✓	✓	✓
RWKD 7	Universal Plus to square adaptor (right hand)	✓	×	×	×	×	×	×	×	×	×	×	×	✓	✓	✓

	Code	Description	White	Cream	Golden Oak	Rosewood	Irish Oak	White Ash	Grey	Warm White	Blue White	Black Ash	Oak	Terracotta	Clay Brown	Brown	Black	
Universal XL 114mm x 71.5mm	RWKD 8	Universal Plus to half-round adaptor (left hand)	✓	×	×	×	×	×	×	×	×	×	×	×	×	✓	✓	
	RWKD 9	Universal Plus to half-round adaptor (right hand)	✓	×	×	×	×	×	×	×	×	×	×	×	×	✓	✓	
	RWXG 4	4m gutter	✓	×	×	×	×	×	×	×	×	×	×	×	×	✓	✓	
	RWXA 1	90° angle	✓	×	×	×	×	×	×	×	×	×	×	×	×	✓	✓	
	RWXA 2	135° angle	✓	×	×	×	×	×	×	×	×	×	×	×	×	✓	✓	
	RWXE 1	Stop end external	✓	×	×	×	×	×	×	×	×	×	×	×	×	✓	✓	
	RWXE 2	Stop end internal	✓	×	×	×	×	×	×	×	×	×	×	×	×	✓	✓	
	RWXFB 1	Fascia bracket	✓	×	×	×	×	×	×	×	×	×	×	×	×	✓	✓	
	RWYO 1	Running outlet	✓	×	×	×	×	×	×	×	×	×	×	×	×	✓	✓	
RWXU 1	Union bracket	✓	×	×	×	×	×	×	×	×	×	×	×	×	✓	✓		
Square downpipes and accessories	RWSP 25	2.5m pipe	✓	×	×	×	×	×	×	×	×	×	×	×	✓	✓	✓	
	RWSP 4	4m pipe	✓	×	×	×	×	×	×	×	×	×	×	×	✓	✓	✓	
	RWSP 55	5.5m pipe	✓	×	×	×	×	×	×	×	×	×	×	×	✓	✓	✓	
	RWSB 1	90° bend	✓	×	×	×	×	×	×	×	×	×	×	×	✓	✓	✓	
	RWSB 2	112° offset bend	✓	×	×	×	×	×	×	×	×	×	×	×	✓	✓	✓	
	RWSB 3	Shoe	✓	×	×	×	×	×	×	×	×	×	×	×	✓	✓	✓	
	RWSC 1	Pipe clip	✓	×	×	×	×	×	×	×	×	×	×	×	✓	✓	✓	
	RWSC 2	Pipe clip - flush	✓	×	×	×	×	×	×	×	×	×	×	×	✓	✓	✓	
	RWSC 3	Single fix downpipe clip	✓	×	×	×	×	×	×	×	×	×	×	×	✓	✓	✓	
	RWSS 1	Pipe socket	✓	×	×	×	×	×	×	×	×	×	×	×	✓	✓	✓	
	RWSY 1	112° branch	✓	×	×	×	×	×	×	×	×	×	×	×	✓	✓	✓	
	Round downpipes and accessories	RWP 25	2.5m pipe	✓	×	×	×	×	×	✓	×	×	×	×	×	✓	✓	✓
		RWP 4	4m pipe	✓	×	×	×	×	×	×	×	×	×	×	×	✓	✓	✓
RWP 55		5.5m pipe	✓	✓	×	×	×	×	✓	×	×	×	×	×	✓	✓	✓	
RWB 1		90° bend	✓	×	×	×	×	×	✓	×	×	×	×	×	✓	✓	✓	
RWB 2		Offset bend 112°	✓	✓	×	×	×	×	✓	×	×	×	×	×	✓	✓	✓	
RWB3		Shoe	✓	✓	×	×	×	×	✓	×	×	×	×	×	✓	✓	✓	
RWC 1		Pipe clip	✓	✓	×	×	×	×	✓	×	×	×	×	×	✓	✓	✓	
RWC 3		Single fix downpipe clip	✓	×	×	×	×	×	×	×	×	×	×	×	✓	✓	✓	
RWS 1		Pipe socket	✓	×	×	×	×	×	✓	×	×	×	×	×	✓	✓	✓	
RWY 1		112° branch	✓	×	×	×	×	×	✓	×	×	×	×	×	✓	✓	✓	
Brackets and adaptors	RWR 1	Top fix rafter bracket	-	-	-	-	-	-	-	-	-	-	-	-	-	-	-	
	RWR 2	Side fix rafter bracket	-	-	-	-	-	-	-	-	-	-	-	-	-	-	-	
	RWD 3	Round to Ogee adaptor (left hand)	✓	×	×	×	×	×	×	×	×	×	×	×	×	✓	✓	
	RWD 4	Round to Ogee adaptor (right hand)	✓	×	×	×	×	×	×	×	×	×	×	×	×	✓	✓	
	RWSD 1	Square to round adaptor	✓	×	×	×	×	×	×	×	×	×	×	×	×	✓	✓	
	RWSD 2	Square to round pipe	✓	×	×	×	×	×	×	×	×	×	×	×	×	✓	✓	
	RWD 2	Round cast to round PVC adaptor	✓	×	×	×	×	×	×	×	×	×	×	×	×	×	✓	
	RWSD 3	Square to Ogee adaptor (left hand)	✓	×	×	×	×	×	×	×	×	×	×	×	×	✓	✓	
	RWSD 4	Square to Ogee adaptor (right hand)	✓	×	×	×	×	×	×	×	×	×	×	×	×	✓	✓	
	RWH 1	Hopper	✓	✓	×	×	×	×	×	×	×	×	×	×	✓	✓	✓	
	RWGG 1	Gutter guard	×	×	×	×	×	×	×	×	×	×	×	×	×	×	✓	
	RWDS 1	Drain smart	×	×	×	×	×	×	×	×	×	×	×	×	×	×	✓	
	RWSB 4	Adjustable offset bend	✓	×	×	×	×	×	×	×	×	×	×	×	×	✓	✓	
	RWOB 1	Balloon guard	×	×	×	×	×	×	×	×	×	×	×	×	×	×	✓	
	RWSD 5	Cut in outlet	✓	×	×	×	×	×	×	×	×	×	×	×	×	×	×	

Branches nationwide

With a nationwide network of 125+ branches, Eurocell can provide a local service wherever you need us. Find your nearest branch below:

MIDLANDS

Alfreton	T: 01773 545810	Leicester	T: 0116 274 2100	Redditch	T: 01527 522222
Birmingham	T: 0121 333 3956	Lincoln	T: 01522 575400	Shrewsbury	T: 01743 469897
Brierley Hill	T: 01384 481263	Lincoln Collect	T: 01522 682222	Stoke South	T: 01782 444570
Cannock	T: 01543 462525	Mansfield	T: 01623 422800	Sutton Coldfield	T: 0121 351 1791
Chesterfield	T: 01246 202968	Newcastle-u-Lyme	T: 01782 566695	Telford	T: 01952 292643
Coventry	T: 024 7663 7229	Northampton	T: 01604 754833	Wolverhampton	T: 01902 424567
Derby	T: 01332 345252	Norwich	T: 01603 789918	Worcester	T: 01905 723579
Ipswich	T: 01473 726770	Nottingham	T: 0115 985 2522		
Kings Lynn	T: 01553 774677	Nuneaton	T: 024 7632 7415		
Leamington Spa	T: 01926 432873	Peterborough	T: 01733 333971		

NORTH

Accrington	T: 01254 395220	Grimsby	T: 01472 340177	Preston	T: 01772 701211
Ashton-under-Lyne	T: 0161 331 9994	Halifax	T: 01422 344110	Rochdale	T: 01706 654020
Bangor	T: 01248 355484	Huddersfield	T: 01484 518115	Rotherham	T: 01709 525580
Barnsley	T: 01226 770844	Hull	T: 01482 606611	Scunthorpe	T: 01724 281195
Birkenhead	T: 0151 650 0090	Keighley	T: 01535 600121	Selby	T: 01757 210200
Blackpool	T: 01253 351515	Kendal	T: 01539 731330	Sheffield	T: 0114 242 1666
Bolton	T: 01204 366272	Leeds	T: 0113 238 1387	Sheffield Collect	T: 0114 278 0230
Bradford	T: 01274 732101	Leeds Collect	T: 0113 249 9242	Stockport	T: 0161 476 2025
Carlisle	T: 01228 513833	Liverpool	T: 0151 933 5353	Sunderland	T: 0191 521 1110
Chester	T: 01244 371700	Manchester	T: 0161 877 8888	Wakefield	T: 01924 298378
Darlington	T: 01325 363686	Middlesbrough	T: 01642 430510	Warrington	T: 01925 414769
Doncaster	T: 01302 881441	Newcastle-u-Tyne	T: 0191 270 1280	Wigan Collect	T: 01942 825559
Gateshead	T: 0191 491 0850	Oldham	T: 0161 626 9966	York	T: 01904 479201

SOUTH

Abingdon	T: 01235 533210	Crayford	T: 01322 553632	Reading	T: 0118 986 1930
Andover	T: 01264 323413	Crawley	T: 01293 514425	Redhill	T: 01737 772596
Barnstaple	T: 01271 376179	Dartford	T: 01322 285320	Romford	T: 01708 381873
Basildon	T: 01268 273463	Enfield	T: 020 8804 9569	Sittingbourne	T: 01795 420003
Basingstoke	T: 01256 478451	Exeter	T: 01392 829721	Southampton	T: 023 8063 4966
Bedford	T: 01234 340825	Folkestone	T: 01303 842223	Southend	T: 01702 616326
Blandford Forum	T: 01258 459367	Gloucester	Opening soon	St Austell	T: 01726 65353
Bognor Regis	T: 01243 867033	Greenford	T: 020 8575 3701	Stevenage	T: 01438 355700
Bow	T: 020 7511 4850	Hastings	T: 01424 854414	Swindon	T: 01793 878771
Bridgwater	T: 01278 453166	Hayes	T: 020 8569 3363	Thanet	T: 01843 589686
Brighton	T: 01273 674959	Luton	T: 01582 562484	Trowbridge	T: 01225 765190
Bristol	T: 0117 971 3371	Medway	T: 01634 294300	Truro	T: 01872 271356
Camberley	T: 01276 671901	Milton Keynes	T: 01908 649501	Wickford	T: 01268 562900
Cardiff	T: 029 2048 6879	Newton Abbott	T: 01626 335585	Worthing	T: 01903 216967
Chelmsford	T: 01245 357000	Plymouth	T: 01752 345629		
Christchurch	T: 01202 482389	Poole	T: 01202 593300		
Colchester	T: 01206 841796	Portsmouth	T: 02392 376290		

IRELAND

Dublin T: 00 353 1460 5383

SCOTLAND

Aberdeen	T: 01224 707660
Coatbridge	T: 01236 424287
Dumfries	T: 01387 269982
Dundee	T: 01382 322577
Glasgow	T: 0141 882 8490
Hawick	T: 01450 363498
Inverness	T: 01463 718488
Irvine	T: 01294 213214
Livingston	T: 01506 443165



**FOR GENERAL
ENQUIRIES,
FREEPHONE**

**08000
77 88 88**

Find your nearest branch
at eurocell.co.uk/branchfinder

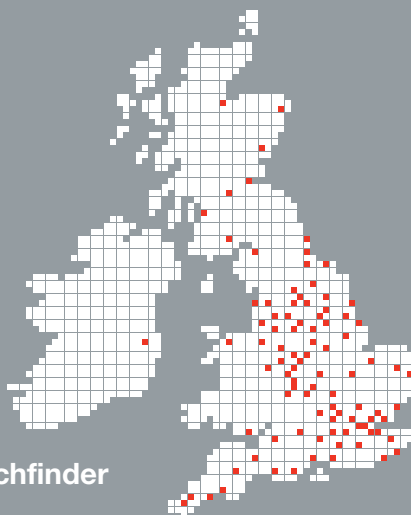



All together better

To find out more information about Eurocell products and services, call our customer care team now on **0800 988 3047**, or visit **www.eurocell.co.uk**

Eurocell Building Plastics, Birchwood Way, Cotes Park Industrial Estate, Alfreton, Derbyshire DE55 4QQ

